



GE
159 Plastics Avenue
Pittsfield, MA 01201
USA

Transmitted via Overnight Courier

December 28, 2010

Mr. Dean Tagliaferro
EPA Project Coordinator
United States Environmental Protection Agency
c/o Weston Solutions, Inc.
10 Lyman Street
Pittsfield, MA 01201

Mr. Richard Fisher (Mail Code OSRR07-1)
United States Environmental Protection Agency
5 Post Office Square - Suite 100
Boston, MA 02109-3912

**Re: GE-Pittsfield/Housatonic River Site
Former Oxbow Areas J and K (GEC420), Lyman Street Area (GEC430), and Newell Street
Area II (GEC450)
Summary of October and November 2010 Tree/Shrub Installation Activities**

Dear Mr. Tagliaferro and Mr. Fisher:

In accordance with the October 2010 inspection summary letters for Former Oxbow Areas J and K, the Lyman Street Area, and Newell Street Area II, GE performed replanting activities in October and November 2010. Attached are restoration planting plan figures providing information on the trees and shrubs planted in October and November 2010 at each of these areas. Schedules for future tree/shrub inspections at the Former Oxbow Areas J and K, the Lyman Street Area, and Newell Street Area II are provided below.

Former Oxbow Areas J and K

Future inspections of the properties located at Former Oxbow Areas J and K will be conducted in accordance with the Post-Removal Site Control requirements specified in the Final Completion Report for the Former Oxbow Areas J and K Removal Action and subsequent agreements between GE and EPA. The trees and shrubs replanted in June, October, and November 2009 will be inspected in May and August or September 2011 to complete the two-year inspection period for those plantings. The trees and shrubs replanted in August, October, and November 2010 will be inspected twice per year (in May and August or September) in both 2011 and 2012. In addition, GE will inspect tree cages, guards, and stakes (where present) on trees/shrubs no longer subject to the two-year monitoring period during future annual inspections (in August or September) until such time as the tree cages are removed.

Lyman Street Area

Future inspections of the properties located at the Lyman Street Area will be conducted in accordance with the Post-Removal Site Control requirements specified in the Final Completion Report for the Lyman Street Area Removal Action and subsequent agreements between GE and EPA. The shrubs replanted on Parcel I9-4-14 in October 2009 will be inspected in May and August or September 2011 to complete the two-year inspection period for those plantings. The new shrubs installed in October 2010 on Parcel I9-4-14 will be

inspected twice per year (in May and August or September) in both 2011 and 2012. (Note that a shrub planted in August 2010 was observed to be dead during the September 2010 inspection and is therefore no longer subject to inspection. That shrub was replaced by one of the shrubs planted in October 2010.)

The shrubs replanted on Parcel I9-8-2 in June, October and November 2009 will be inspected in May and August or September 2011 to complete the two-year inspection period for those plantings. The trees and shrubs planted in August 2010 and the new shrubs installed in October 2010 on Parcel I9-8-2 will be inspected twice per year (in May and August or September) in both 2011 and 2012.

In addition, GE will inspect tree cages, guards, and stakes (where present) on trees/shrubs no longer subject to the two-year monitoring period during future annual inspections (in August or September) until such time as the tree cages are removed.

Newell Street Area II

Future inspections of the properties located at Newell Street Area II will be conducted in accordance with the Post-Removal Site Control requirements included in the Final Completion Report for the Newell Street Area II Removal Action. Although the two-year monitoring period for the trees/shrubs installed in 2006 and 2008 has been completed, GE will continue to inspect the four stressed original lowbush blueberries and one stressed lowbush blueberry replanted in May 2008 in Planting Area 24, located in the area of the large wooden mats used by Western Massachusetts Electric Company on Parcel J9-23-8, for one more year (in May and August or September 2011). Additionally, the trees and shrubs installed in June and November 2009 will be inspected in May and August or September 2011 to complete the two-year inspection period for those plantings. The shrub installed in August 2010 and the new trees and shrubs installed in October and November 2010 will be inspected in May and August or September in both 2011 and 2012. In addition, GE will inspect tree cages, guards, and stakes (where present) on trees/shrubs no longer subject to the two-year monitoring period during future annual inspections (in August or September) until such time as the tree cages are removed.

Please call me if you have any comments or questions.

Sincerely

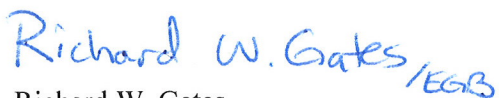

Richard W. Gates
Remediation Project Manager

Attachment

cc:	Rose Howell, EPA*	Linda Palmieri, Weston (2 copies)
	Holly Inglis, EPA	Michael Carroll, GE*
	Tim Conway, EPA*	Rod McLaren, GE*
	Michael Gorski, MDEP*	Peter Wojcik, GE*
	Eva Tor, MDEP*	James Nuss, ARCADIS
	John Ziegler, MDEP (2 copies)	James Bieke, Goodwin Procter
	Karen Pelto, MDEP*	Public Information Repositories
		GE Internal Repository

* cover letter only

CITY: SYRACUSE, NY; DIV: GROUP; ENV: 141; DB: G. STOWELL; E: KRAHMER, L.; FORAKER, L.; PIC: P. KEANEY; PM: C. AVERILL; TM: A. CORBIN; LYR: ON; OFF: REF; V: A; ENVCAD: SYRACUSE; ACT: MB; 0030910000000001; DWG: LYMAN PLANTING; 309100301; DWG LAYOUT: 3S; SAVED: 12/27/2010 12:47 PM; ACADVER: 18.05 (LMS TECH); PAGES: 2/18; PLOT: 12/27/2010 12:48 PM; BY: FORAKER, LYDIA; C: LD2B; PDF: PLOT; STYLE: TABLE; PLT: FULL; CTB: PLOT; PLOTTED: 12/27/2010 12:48 PM; BY: FORAKER, LYDIA

SPECIES	ORIGINALLY PLANTED TREES/SHRUBS		
	19-4-14	19-4-14 AND 19-4-19	19-8-2
Black Willow (Salix nigra)	5	45	--
Silver Maple (Acer saccharinum)	--	45	--
Box Elder (Acer negundo)	5	44	9
Cottonwood (Populus deltoides)	--	--	8
White Pine (Pinus strobus)	--	--	1
Northern Red Oak (Quercus rubra)	--	--	1
Quaking Aspen (Populus tremuloides)	--	--	14
Red Osier Dogwood (Cornus sericea)	--	40	30
Silky Dogwood (Cornus amomum)	10	25	--
Winterberry Holly (Ilex verticillata)	10	25	--
Northern Arrowwood (Viburnum dentatum)	10	25	10
Choke Cherry (Prunus virginiana)	10	25	10

PARCEL	SPECIES	REPLANTED TREES/SHRUBS	
		INSTALLATION DATE	HEIGHT (FT) AT TIME OF INSTALLATION
19-4-14	Choke Berry ^F (Aronia arbutifolia)	October 2009 ^A	2
	Choke Cherry ^F (Prunus virginiana)	October 2010	2
	Choke Cherry ^F (Prunus virginiana)	October 2009	3
	Choke Cherry ^F (Prunus virginiana)	October 2010	2
19-8-2	Black Cherry (Prunus serotina)	July 2008 ^C	5
	Choke Berry (Aronia arbutifolia)	November 2009 ^D	3
	Choke Berry (Aronia arbutifolia)	August 2010 ^E	3
	Choke Berry (Aronia arbutifolia)	August 2010 ^E	3
	Choke Berry (Aronia arbutifolia)	August 2010 ^E	3
	Choke Berry (Aronia arbutifolia)	August 2010 ^E	3
	Choke Berry (Aronia arbutifolia)	October 2010 ^E	2
	Choke Berry (Aronia arbutifolia)	October 2010 ^E	2
	Choke Berry (Aronia arbutifolia)	October 2010 ^E	2
	Choke Berry (Aronia arbutifolia)	October 2010 ^E	2
19-8-2	Choke Cherry (Prunus virginiana)	October 2008	2
	Choke Cherry (Prunus virginiana)	October 2010	2
	Cottonwood (Populus deltoides)	July 2008	3
	Cottonwood (Populus deltoides)	July 2008	5
	Cottonwood (Populus deltoides)	August 2010	3
	Cottonwood (Populus deltoides)	August 2010	3
	Cottonwood (Populus deltoides)	August 2010	3
	Northern Arrowwood ^F (Viburnum dentatum)	June 2009	2
	Quaking Aspen (Populus tremuloides)	July 2008	6
	Quaking Aspen (Populus tremuloides)	July 2008	8
19-4-27	Red Osier Dogwood ^F (Cornus sericea)	July 2008	5
	Red Osier Dogwood ^F (Cornus sericea)	October 2008	3
	Red Osier Dogwood ^F (Cornus sericea)	October 2009	3
	Red Osier Dogwood ^F (Cornus sericea)	October 2010	2
19-4-27	White Pine (Pinus strobus)	May 2008	6

- A. During the September 2010 inspection, it was noted that one Choke Berry was inadvertently planted in place of a Winterberry Holly in October 2009 (and tagged as a Winterberry Holly).
- B. One Northern Arrowwood planted in October 2008 on parcel 19-4-14 was removed due to mortality observed during the May 2010 inspection.
- C. Based on discussions between GE and EPA, one Black Cherry was planted to replace one dead Choke Cherry identified in the May 2008 inspection.
- D. One Choke Berry was planted to replace one Choke Cherry that could not be located during the September 2009 inspection.
- E. Choke Berries were planted to replace dead Northern Arrowwoods identified during the May or September 2010 inspection.
- F. One Choke Berry planted in August 2010 and one Choke Cherry planted in October 2008 on parcel 19-4-14 and one Northern Arrowwood planted in October 2008 and one Red Osier Dogwood planted in June 2009 on parcel 19-8-2 were removed due to mortality observed during the September 2010 inspection.

* TREES AND SHRUBS PLANTED EVENLY THROUGHOUT PLANTING AREAS
 ** SEE NOTE 3

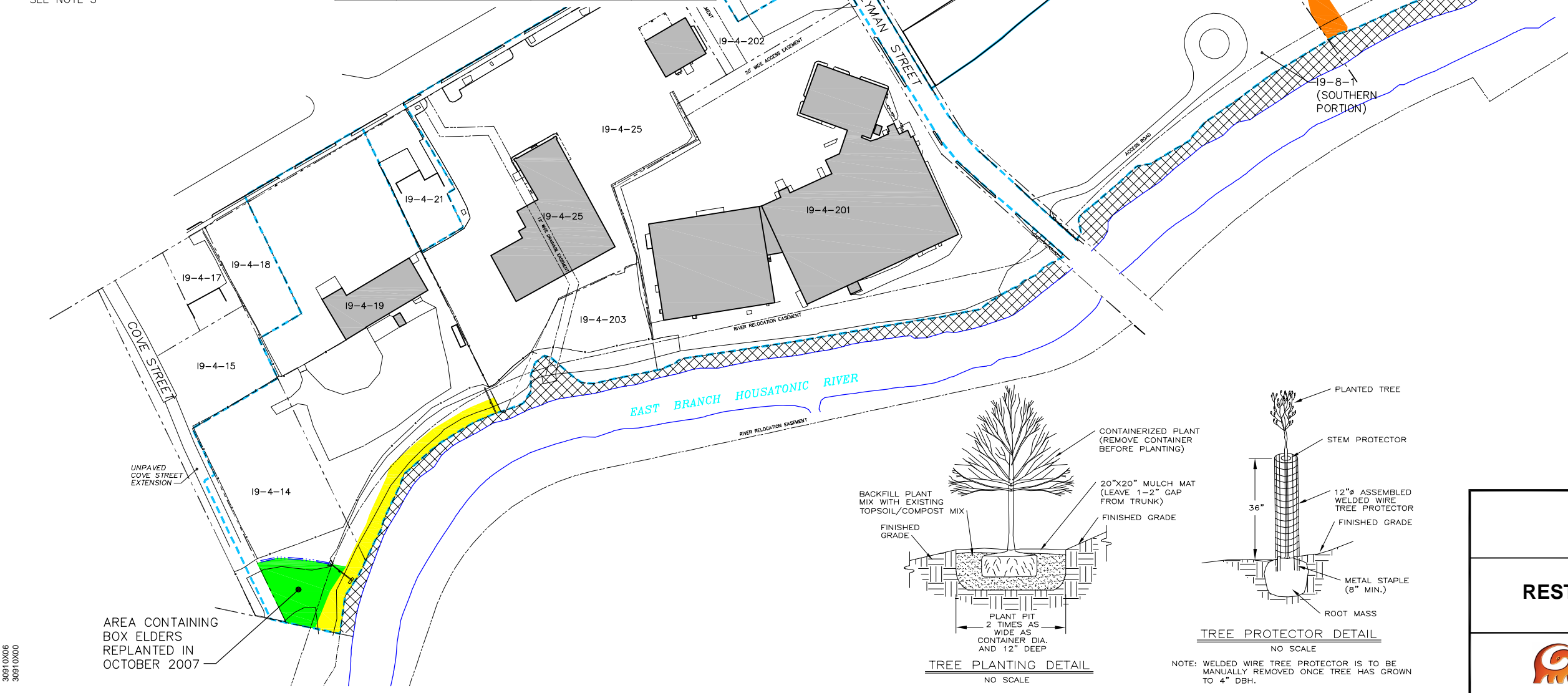

LEGEND

- APPROXIMATE RAA BOUNDARY
- PARCEL BOUNDARY
- 19-8-3 PARCEL ID
- CHAIN LINK FENCE
- WOODEN FENCE
- BUILDING
- AREA ADDRESSED AS PART OF 1/2-MILE REACH REMOVAL ACTION OR 1 1/2-MILE REACH REMOVAL ACTION
- PLANTING AREA 1 (SEE PLANTING PLAN FOR DETAILS)
- PLANTING AREA 2 (SEE NOTE 3)
- PLANTING AREA 3 (SEE PLANTING PLAN FOR DETAILS)

- NOTES:**
- MAPPING IS BASED ON SITE SURVEYS BY HILL ENGINEERS, ARCHITECTS & PLANNERS INC., DATED 2/5/04 AND 10/15/07 AND FROM AERIAL PHOTOGRAPHS AND PHOTOGRAMMETRIC MAPPING BY LOCKWOOD MAPPING, INC. - FLOWN IN APRIL 1990 (EDGE OF RIVER).
 - BASEMAP MODIFIED FROM SURVEY DRAWINGS NOS. 06-05-09-LE AND 06-05-09-LA (7/7/06, 6/15/06) BY WHITE ENGINEERING, INC.
 - PLANTING AREA 2 IS NOT INSPECTED AS PART OF POST-REMOVAL SITE CONTROL ACTIVITIES FOR THE LYMAN STREET AREA, BUT AS PART OF POST-REMOVAL SITE CONTROL ACTIVITIES FOR THE 1/2 MILE REACH.

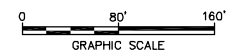
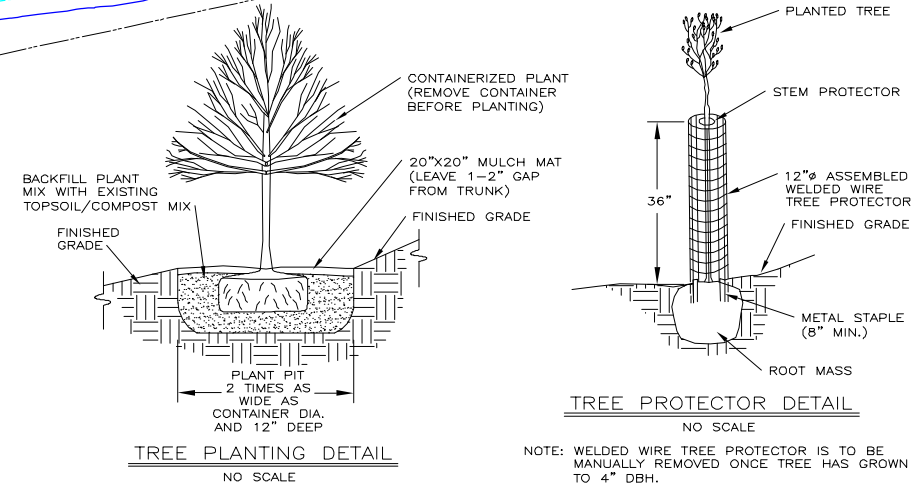

GENERAL ELECTRIC COMPANY
PITTSFIELD, MASSACHUSETTS
LYMAN STREET AREA

RESTORATION PLANTING PLAN

FIGURE
3

