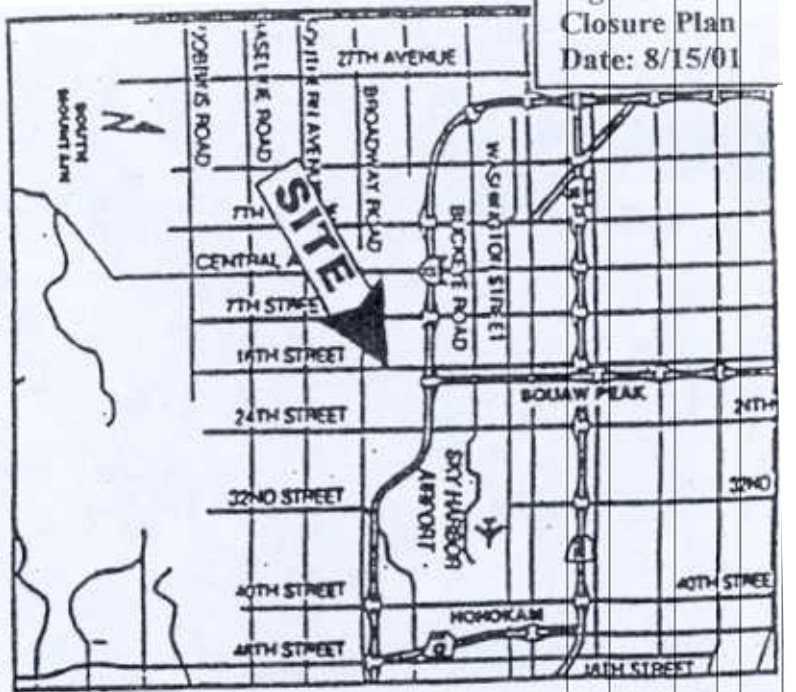

Figure 1
 Closure Plan
 Date: 8/15/01



LIGHTING RESOURCES, INC.
Group and Bulbless Disposal

Lighting
 General
 Commercial
 Residential
 Construction
 Specialties
 Specialties

BEN MECHE
 Branch Manager

1522 E. Victory Street, Suite 104
 Phoenix, Arizona 85040

(602) 278-4278
 (602) 572-8253
 Fax (602) 278-6432

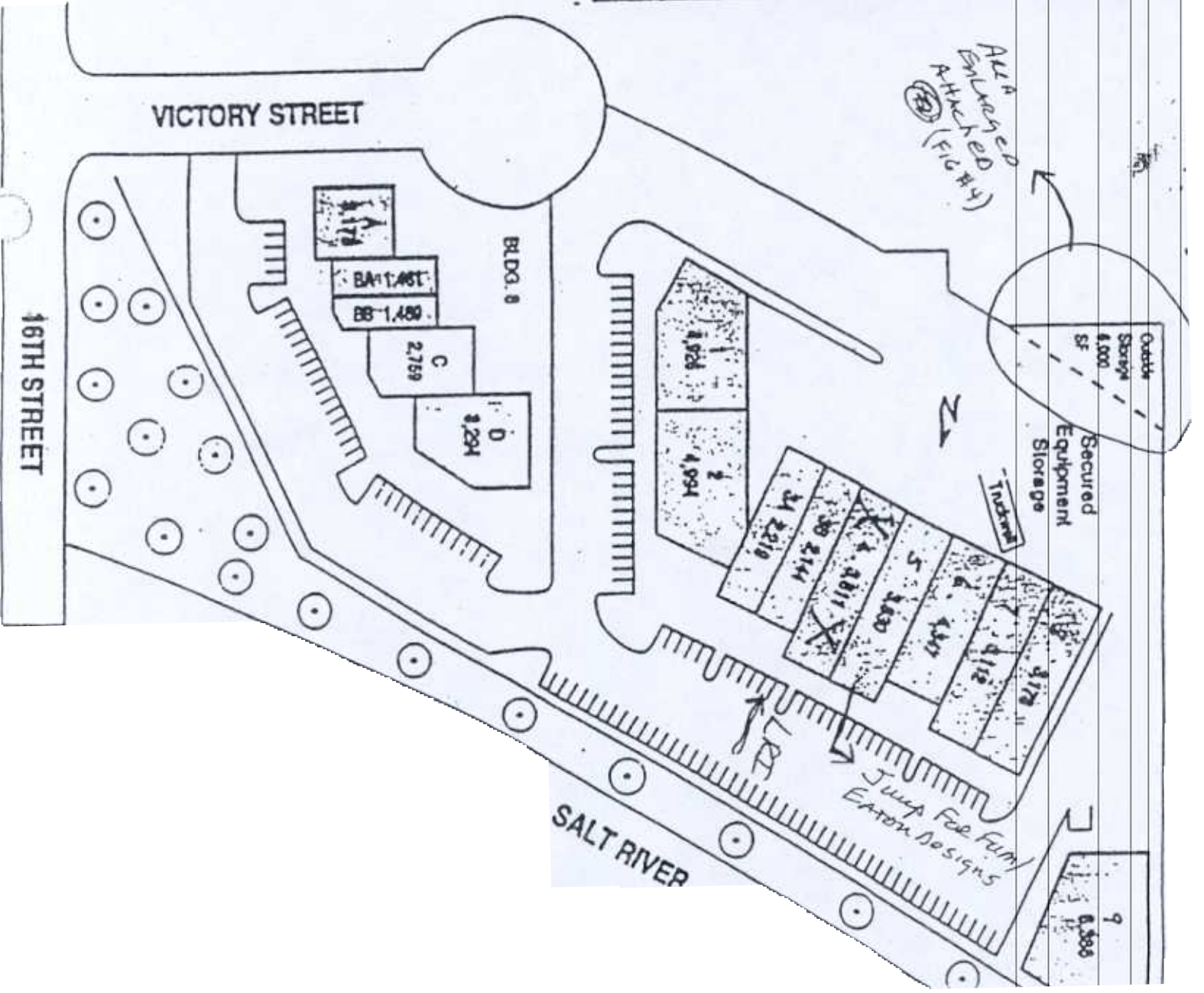

Figure 2 Closure Plan
Scale: 1" = 10'
Date 7/16/01

File: Operational Areas
Lighting Resources Inc.
Drawn by R. Mann

Storage for 70 Ballast
Drums (double stacked)

Notes

- 14. Vise Table
- 15. Core Dump Table
- * Empty containers and non-regulated materials stored where room is available
- * Air-compressors, air tools, bandsaw, and other small tools not specified in print
- * Metal storage in roll-offs outside as Specified in Quality Assurance Policy

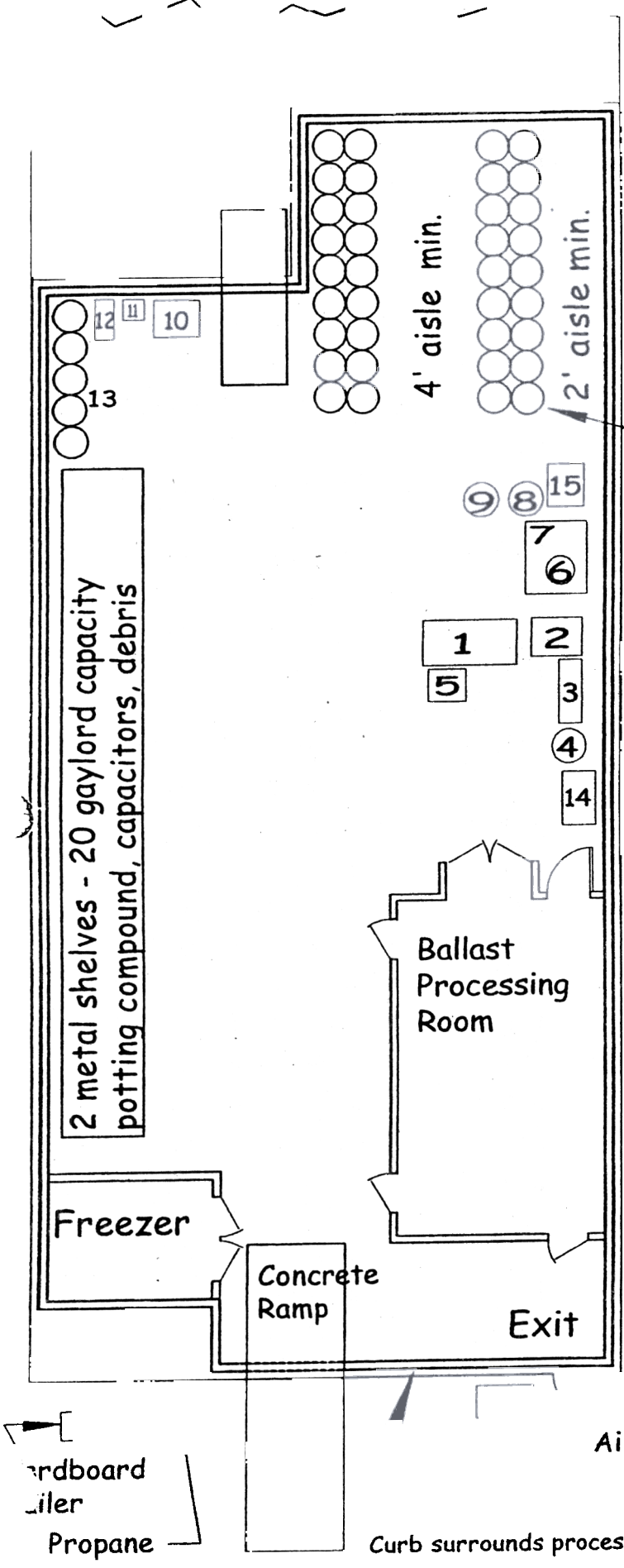

Aircressor

Curb surrounds processing and storage area

Cardboard
Pallet
Propane