

Beazer East, Inc.

Former Koppers Wood-Treating Site – Carbondale, Illinois

Soil Removal and Surface Cover Remediation Project

Weekly Report #10: 12/14/20 – 12/20/20



**Soil Removal and Surface Cover
Former Koppers Wood-Treating Site
Carbondale, IL**

WEEKLY PROGRESS REPORT

Reporting Period: Monday, December 14th, 2020 to Sunday, December 20th, 2020

Progress Meeting Date: Tuesday, December 15th, 2020

1.0 Weather Conditions

Date	Conditions	Wind	Precipitation (in)
Monday 12/14/20	Partly Cloudy, 25-41 °F	9.6/NNW	0
Tuesday 12/15/20	Cloudy, 20-37 °F	9.6/E	0
Wednesday 12/16/20	Morning Snow/Overcast, 23-33 °F	6.3/NNW	Trace
Thursday 12/17/20	Partly Cloudy, 19-41 °F	4.3/NW	0
Friday 12/18/20	Partly Cloudy, 22-46 °F	7.6/SSE	Trace
Saturday 12/19/20	Cloudy, 40-44 °F	7.8/SSW	0
Sunday 12/20/20	Not On-Site		0
Week Total			0
Site Cumulative			8.99

2.0 Health & Safety

Manhours Completed this Period: 680.5

Manhours Completed to Date: 5387.5

Notes

Day	Tailgate Topic(s)
Monday	Staying focused on the jobsite
Tuesday	Proper layering of clothes and importance of not overheating
Wednesday	Cold weather hazards and slip hazards due to ice
Thursday	COVID-19 protocols onsite and offsite
Friday	Traffic awareness and speeding cars when entering and exiting site
Saturday	Wind hazards with swinging doors and staying focused on the jobsite
Sunday	-

3.0 ENTACT Work Activities Summary

Monday – December 14, 2020
Began placement and grading of vegetative cover over previously placed general fill in Soil Removal Area 1. Pumped contact water out of Soil Removal Area 1 and Soil Removal Area 2 (water pumped to on-site wastewater treatment plant (WWTP) with sediments removed via a filter bag). Continued placement of geotextile and began placement of general fill/vegetative cover in Soil Removal Area 2. Began preparation of Surface Cover Area 1 subgrade.
Tuesday – December 15, 2020
Continued placement and grading of vegetative cover over previously placed general fill in Soil Removal Area 1. Pumped contact water out of Soil Removal Area 2 (water pumped to on-site WWTP with sediments removed via a filter bag). Continued placement of geotextile and general fill/vegetative cover in Soil Removal Area 2. Continued preparation of Surface Cover Area 1 subgrade.
Wednesday – December 16, 2020
Geotextile was placed in the approved excavated portions of the wetlands portion of Soil Removal Area 1. Continued placement of geotextile and general fill/vegetative cover in Soil Removal Area 2. Completed preparation of Surface Cover Area 1 subgrade. Began placement of vegetative cover and fine grading in Surface Cover Area 3, using stockpiled fill material.
Thursday – December 17, 2020
Continued placement and grading of vegetative cover over previously placed general fill in Soil Removal Area 1. Continued placement of general fill/vegetative cover in the approved excavated portions of the wetlands portion of Soil Removal Area 1. Continued placement of geotextile and general fill/vegetative cover in Soil Removal Area 2. Continued placement of vegetative cover and fine grading in Surface Cover Area 3.
Friday – December 18, 2020
Continued placement and grading of vegetative cover over previously placed general fill in Soil Removal Area 1. Continued placement of general fill/vegetative cover in the approved excavated portions of the wetlands portion of Soil Removal Area 1. Completed placement of geotextile and general fill/vegetative cover in Soil Removal Area 2. Continued placement of vegetative cover and fine grading in Surface Cover Area 3.
Saturday – December 19, 2020
Continued placement and grading of vegetative cover over previously placed general fill in Soil Removal Area 1. Continued placement of general fill/vegetative cover in the approved excavated portions of the wetlands portion of Soil Removal Area 1. Continued placement of vegetative cover and fine grading in Surface Cover Area 3 and in Surface Cover Area 2.
Sunday – December 20, 2020
Not On-Site

4.0 ENTACT Subcontractors

Date	Subcontractor/Vendor/ Third Party	Work Activity
12/15/2020	Shawnee Professional Services	Surveyed Soil Removal Area 1 wetlands portion excavation and final grade in Soil Removal Area 1
12/17/2020	Shawnee Professional Services	Surveyed final grades in Soil Removal Areas 1 and 2 and subgrade in Surface Cover Area 1
12/18/2020	Fabick	Maintenance of ENTACT owned equipment

5.0 ENTACT Deliveries

Material Import – Current Week		
Date	Description	Quantity
12/14/2020	General Fill/Vegetative Cover	2086 tons
12/15/2020	General Fill/Vegetative Cover	2053 tons
12/16/2020	General Fill/Vegetative Cover	177 tons
12/17/2020	General Fill/Vegetative Cover	1900 tons
12/17/2020	CA-2	66.87 tons
12/18/2020	General Fill/Vegetative Cover	2203 tons
12/19/2020	General Fill/Vegetative Cover	1834 tons

Material Import – To Date	
Description	Quantity
General Fill	23887.60 tons
General Fill/Vegetative Cover	13516.94 tons
CA-2	1953.01 tons
Demarcation Fabric	747000 SF
Filter Sock	10230 LF
RipRap-1	133.37 tons

6.0 Material Export

No material export this week.

Material Export – To Date	
Description	Quantity
Impacted Soils	22551.85 tons

7.0 Construction Quality Control

See Attached Reports and Logs:



- Progress Photos
- Progress Map
- Current Project Schedule

8.0 Request for Information (RFIs)

- RFI 001 – Stabilized Construction Entrance Aggregate (Approved)
- None pending

9.0 Change in Conditions

- Borrow material from Shawnee Sand and Gravel corresponding to samples GF-03 and GF-04 was approved for use as both General Fill and Vegetative Cover Soil (per Submittal 019A). Previously, borrow material from Shawnee Sand and Gravel corresponding to sample GF-02 was approved for use as General Fill only (per Submittal 011).

Picture Number	1	
Date	12/14	
Direction	S	
Description: Grading vegetative cover soil to final grade in Soil Removal Area 1.		
Picture Number	2	
Date	12/16	
Direction	SE	
Description: Preparing Surface Cover Area 1 subgrade and excavating ditches.		

Picture Number	3	
Date	12/18	
Direction	SW	
Description: Soil Removal Area 2 completely backfilled and graded.		
Picture Number	4	
Date	12/19	
Direction	SW	
Description: Grading vegetative cover soil layer in Surface Cover Area 3.		

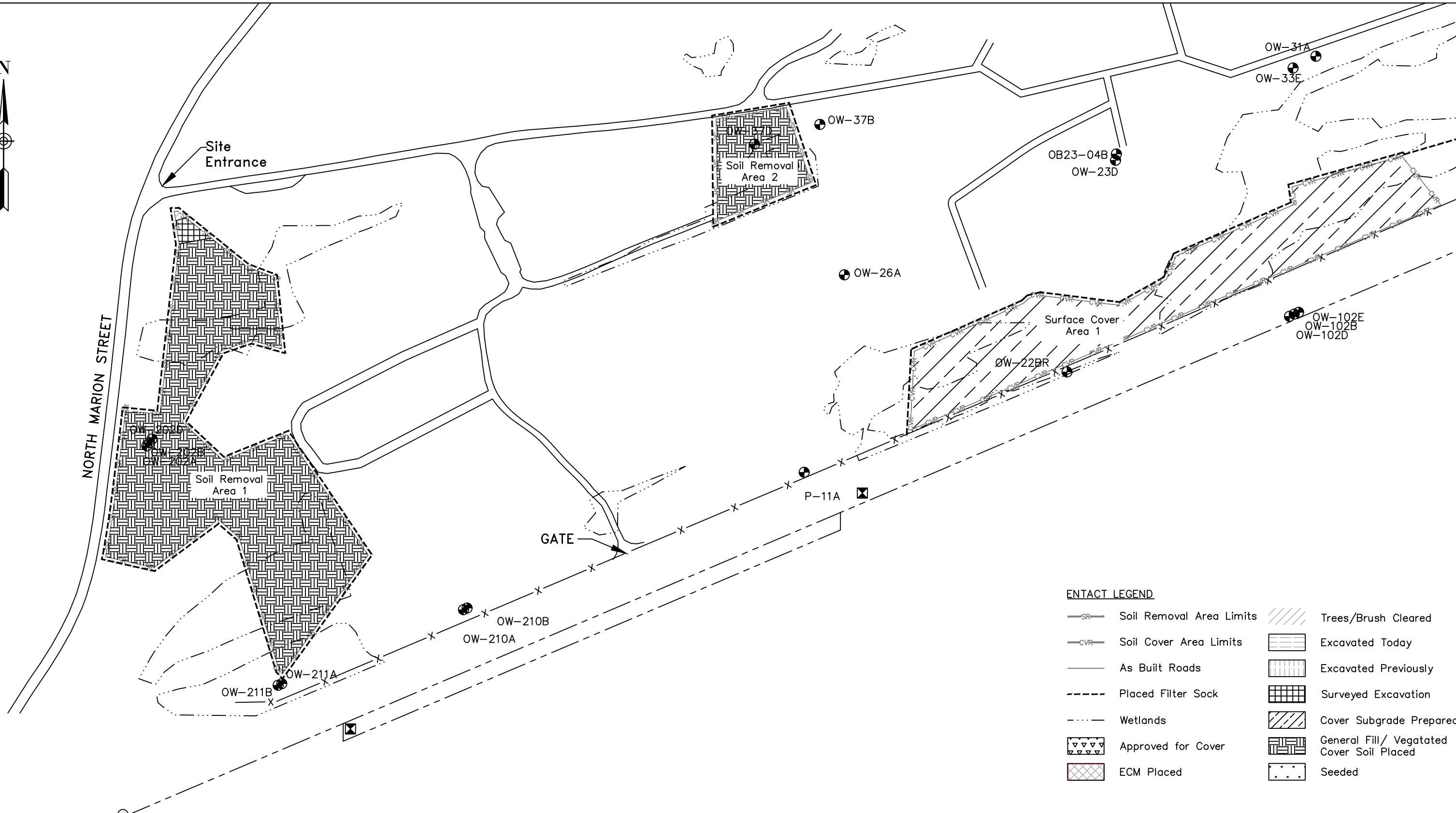

ENTACT LEGEND

Soil Removal Area Limits	Trees/Brush Cleared
Soil Cover Area Limits	Excavated Today
As Built Roads	Excavated Previously
Placed Filter Sock	Surveyed Excavation
Wetlands	Cover Subgrade Prepared
Approved for Cover	General Fill/ Vegetated Cover Soil Placed
ECM Placed	Seeded

REV	DATE	BY	CHK'D	APR'VD	DESCRIPTION

PREPARED FOR:
BEAZER EAST
PITTSBURGH, PA

SCALE: 1"=200'

ENTACT

DRAWING NAME: **Daily Progress Figure – Site West**

PROJECT NAME & LOCATION: **SOIL REMOVAL AND SURFACE COVER REMEDY
FORMER KOPPERS WOOD-TREATING SITE
CARBONDALE, IL**

DRAWN BY	K. KLIPPSTEIN	APPROVED BY	T. MORAN	REV	0	SHEET NO.
DATE	12/19/2020	DATE		PROJECT NO.	E8658	1 OF 2

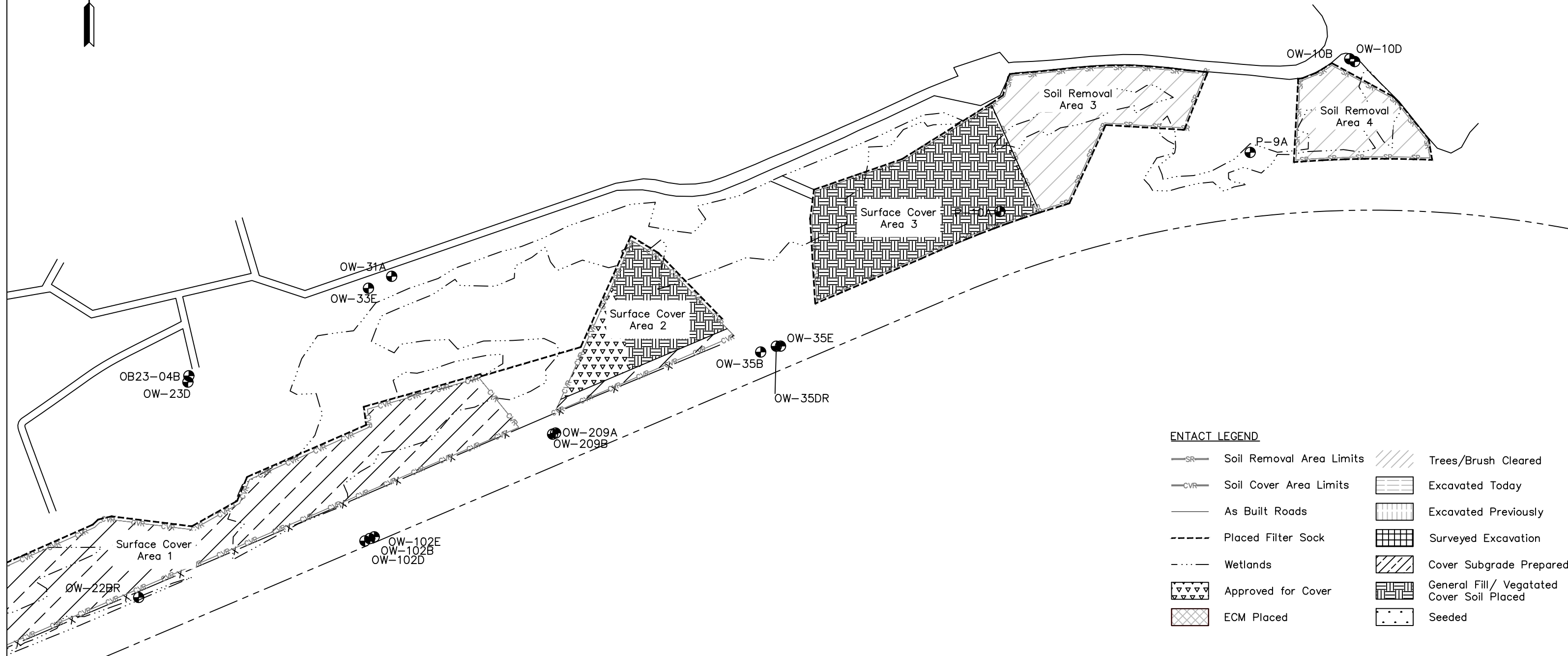

ENTACT LEGEND

SR	Soil Removal Area Limits		Trees/Brush Cleared
CVR	Soil Cover Area Limits		Excavated Today
	As Built Roads		Excavated Previously
	Placed Filter Sock		Surveyed Excavation
	Wetlands		Cover Subgrade Prepared
	Approved for Cover		General Fill/ Vegetated Cover Soil Placed
	ECM Placed		Seeded

REV	DATE	BY	CHK'D	APR'VD	DESCRIPTION

PREPARED FOR:
BEAZER EAST
PITTSBURGH, PA

SCALE: 1"=200'

ENTACT

DRAWING NAME: **Daily Progress Figure - Site East**

PROJECT NAME & LOCATION: **SOIL REMOVAL AND SURFACE COVER REMEDY
FORMER KOPPERS WOOD-TREATING SITE
CARBONDALE, IL**

DRAWN BY	K. KLIPPSTEIN	APPROVED BY	T. MORAN	REV	0	SHEET NO.
DATE	12/19/2020	DATE		PROJECT NO.	E8658	2 OF 2

Beazer East, Inc.
Soil Removal and Surface Cover Remedial Design
Former Koppers Wood-Treating Site
Carbondale, Illinois

