

Beazer East, Inc.

Former Koppers Wood-Treating Site – Carbondale, Illinois

Soil Removal and Surface Cover Remediation Project

Weekly Report #12: 1/4/21 – 1/10/21



**Soil Removal and Surface Cover
Former Koppers Wood-Treating Site
Carbondale, IL**

WEEKLY PROGRESS REPORT

Reporting Period: Monday, January 4th, 2020 to Sunday, January 10th, 2021

Progress Meeting Date: Tuesday, January 5th, 2020

1.0 Weather Conditions

Date	Conditions	Wind	Precipitation (in)
Monday 1/4/21	Sunny, 24-55 °F	6.5/N	0
Tuesday 1/5/21	Partly Cloudy, 28-53 °F	6.9/NNW	0
Wednesday 1/6/21	Sunny, 26-46 °F	8.5/E	0
Thursday 1/7/21	Cloudy, 31-38 °F	8.5/NE	0
Friday 1/8/21	Cloudy, 33-36 °F	7.6/NNW	0
Saturday 1/9/21	Partly Cloudy, 30-35 °F	6.5/NNW	0
Sunday 1/10/21	Not On-Site		0
Week Total			0
Site Cumulative			10.63

2.0 Health & Safety

Manhours Completed this Period: 685

Manhours Completed to Date: 6598

Notes

Day	Tailgate Topic(s)
Monday	Caution of ice and frost on or around equipment
Tuesday	Changing traffic patterns and observe any and all hazards on site access roads
Wednesday	Slips, trips, and falls
Thursday	Cold weather hazards and the importance of wearing layers
Friday	Spotting vehicles that are backing up on site, sight lines, and proper distancing away from machines/vehicles
Saturday	Pinch points
Sunday	-

3.0 ENTACT Work Activities Summary

Monday – January 4, 2021
Continued pumping non-contact surface rainwater to an on-site location outside of the work areas for infiltration. Impacted material from Soil Removal Area 3 was loaded out for transport to Southern Illinois Regional Landfill. Continued construction of access road to Surface Cover Area 1.
Tuesday – January 5, 2021
Impacted material from Soil Removal Area 3 was loaded out for transport to Southern Illinois Regional Landfill. Placed geotextile and general fill/vegetative cover in Surface Cover Area 1.
Wednesday – January 6, 2021
Impacted material from Soil Removal Area 3 was loaded out for transport to Southern Illinois Regional Landfill. Placed geotextile and general fill/vegetative cover in Surface Cover Area 1.
Thursday – January 7, 2021
Impacted material from Soil Removal Area 3 was loaded out for transport to Southern Illinois Regional Landfill. Placed geotextile and general fill/vegetative cover in Surface Cover Area 1.
Friday – January 8, 2021
Continued excavation of impacted material in Soil Removal Area 3. Impacted material from Soil Removal Area 3 was loaded out for transport to Southern Illinois Regional Landfill. Placed geotextile and general fill/vegetative cover in Surface Cover Area 1.
Saturday – January 9, 2021
Continued excavation of impacted material in Soil Removal Area 3. Impacted material from Soil Removal Area 3 was loaded out for transport to Southern Illinois Regional Landfill. Placed geotextile and general fill/vegetative cover in Surface Cover Areas 1 and 2.
Sunday – January 10, 2021
Not On-Site

4.0 ENTACT Subcontractors

Date	Subcontractor/Vendor/ Third Party	Work Activity
1/4/2021	Shawnee Professional Services	Surveyed finished work areas around site
1/4/2021	Fabick CAT	Performed maintenance and repair of ENTACT equipment
1/5/2021	Fabick CAT	Performed maintenance and repair of ENTACT equipment
1/7/2021	Shawnee Professional Services	Surveyed Soil Removal Areas 1 and 2 and Surface Cover Areas 1, 2, and 3
1/8/2021	Fabick CAT	Performed maintenance and repair of ENTACT equipment
1/8/2021	United Rentals	Performed regular maintenance of rental equipment

5.0 ENTACT Deliveries

Equipment - Mobilization		
Date	Description	Quantity
1/4/2021	CAT Dozer D6	1

Equipment - Demobilization		
Date	Description	Quantity
1/4/2021	CAT Dozer D6	1

Material Import – Current Week		
Date	Description	Quantity
1/5/2021	General Fill/Vegetative Cover	940 tons
1/6/2021	General Fill/Vegetative Cover	847 tons
1/7/2021	General Fill/Vegetative Cover	488 tons
1/7/2021	CA-2	48.96 tons
1/8/2021	General Fill/Vegetative Cover	729 tons
1/9/2021	General Fill/Vegetative Cover	1297 tons

Material Import – To Date	
Description	Quantity
General Fill	23887.60 tons
General Fill/Vegetative Cover	22129.46 tons
CA-2	2374.71 tons
Demarcation Fabric	747000 SF
Filter Sock	10230 LF
RipRap-1	231.74 tons

6.0 Material Export

Material Export– Current Week		
Date	Description	Quantity
1/4/2021	Impacted Soils	1343.97 tons
1/5/2021	Impacted Soils	1182.7 tons
1/6/2021	Impacted Soils	1156.72 tons
1/7/2021	Impacted Soils	1159.9 tons
1/8/2021	Impacted Soils	984.01 tons
1/9/2021	Impacted Soils	819.44 tons

Material Export – To Date	
Description	Quantity
Impacted Soils	29198.59 tons

7.0 Construction Quality Control

See Attached Reports and Logs:



- Progress Photos
- Progress Map
- Current Project Schedule

8.0 Request for Information (RFIs)

- RFI 001 – Stabilized Construction Entrance Aggregate (Approved)
- None pending

9.0 Change in Conditions

- Borrow material from Shawnee Sand and Gravel corresponding to samples GF-03 and GF-04 was approved for use as both General Fill and Vegetative Cover Soil (per Submittal 019A). Previously, borrow material from Shawnee Sand and Gravel corresponding to sample GF-02 was approved for use as General Fill only (per Submittal 011)

Picture Number	1	
Date	1/04	
Direction	S	
Description: Load out of impacted material from Soil Removal Area 3.		
Picture Number	2	
Date	1/06	
Direction	W	
Description: Placement of geo-textile and grading of general fill/ vegetative cover over Surface Cover Area 1.		
Picture Number	3	
Date	1/06	
Direction	E	
Description: Consolidation of impacted material from Soil Removal Area 3 into a stockpile for continued load out.		

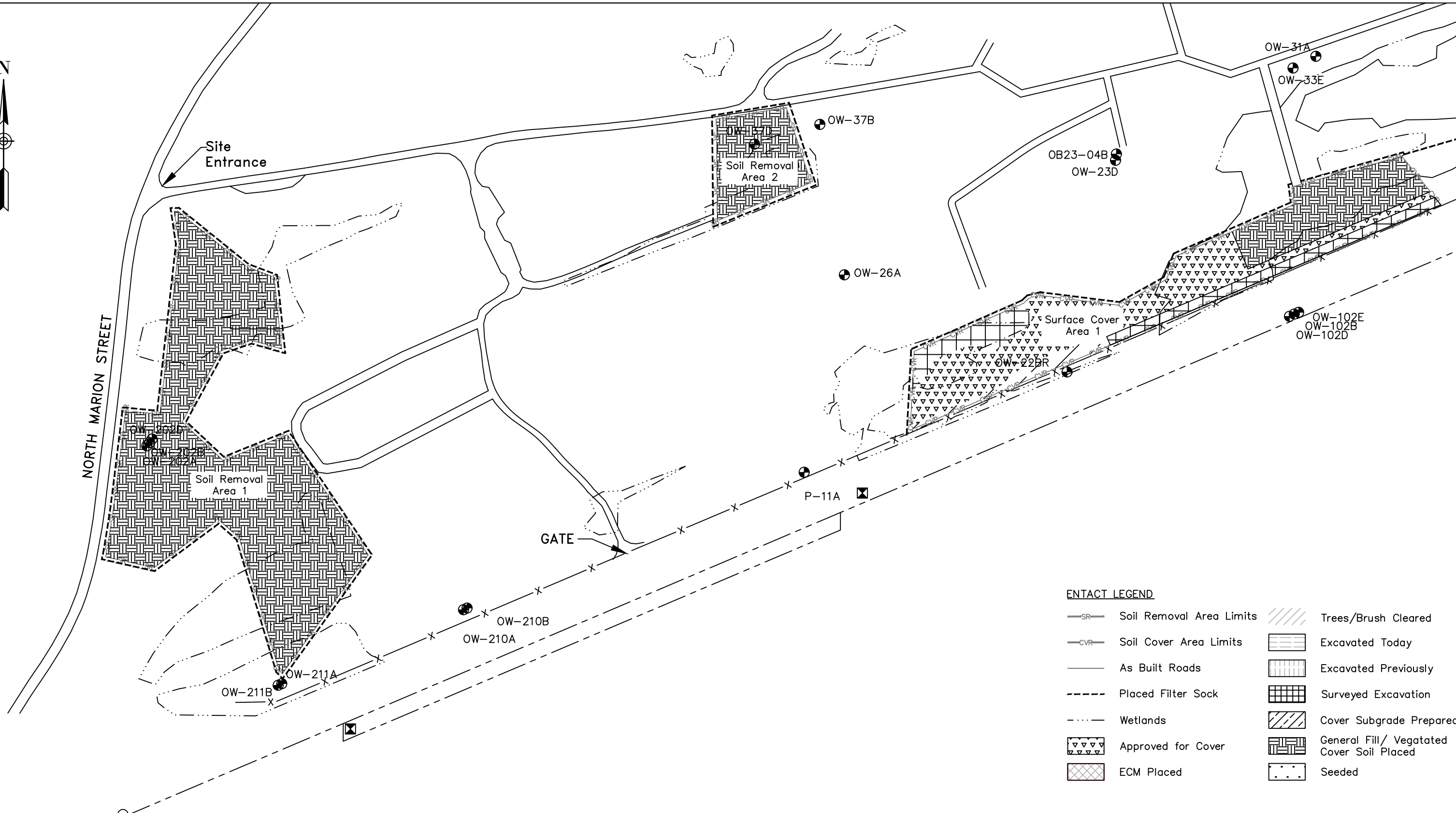

ENTACT LEGEND

Soil Removal Area Limits	Trees/Brush Cleared
Soil Cover Area Limits	Excavated Today
As Built Roads	Excavated Previously
Placed Filter Sock	Surveyed Excavation
Wetlands	Cover Subgrade Prepared
Approved for Cover	General Fill/ Vegetated Cover Soil Placed
ECM Placed	Seeded

REV	DATE	BY	CHK'D	APR'VD	DESCRIPTION

PREPARED FOR:
BEAZER EAST
PITTSBURGH, PA

SCALE: 1"=200'

ENTACT

DRAWING NAME: **Daily Progress Figure – Site West**

PROJECT NAME & LOCATION: **SOIL REMOVAL AND SURFACE COVER REMEDY
FORMER KOPPERS WOOD-TREATING SITE
CARBONDALE, IL**

DRAWN BY	K. KLIPPSTEIN	APPROVED BY	T. MORAN	REV	0	SHEET NO.
DATE	1/09/2021	DATE		PROJECT NO.	E8658	1 OF 2

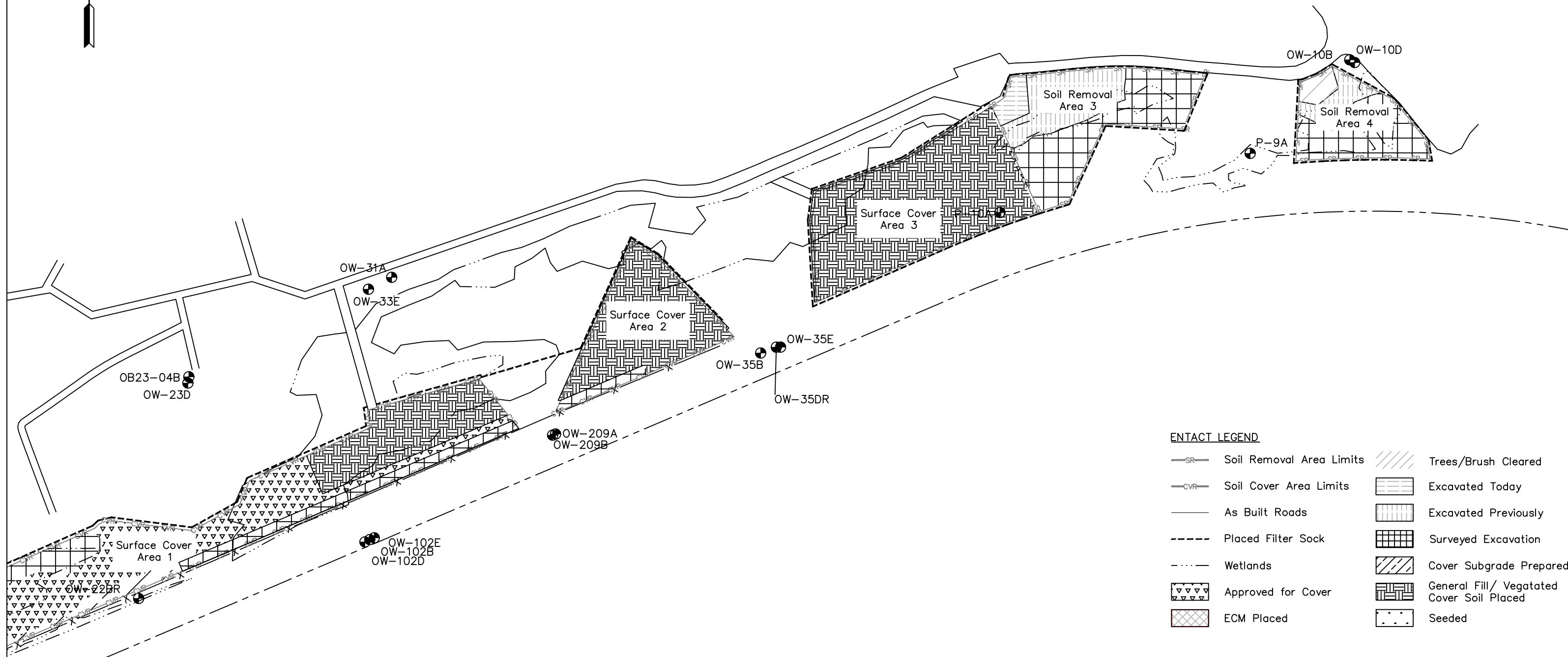

ENTACT LEGEND

- SR Soil Removal Area Limits
- CVR Soil Cover Area Limits
- As Built Roads
- Placed Filter Sock
- Wetlands
- Approved for Cover
- ECM Placed
- Trees/Brush Cleared
- Excavated Today
- Excavated Previously
- Surveyed Excavation
- Cover Subgrade Prepared
- General Fill/ Vegetated Cover Soil Placed
- Seeded

REV	DATE	BY	CHK'D	APR'VD	DESCRIPTION

PREPARED FOR:
BEAZER EAST
PITTSBURGH, PA

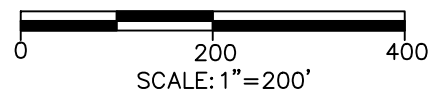

ENTACT

DRAWING NAME: Daily Progress Figure - Site East

PROJECT NAME & LOCATION: SOIL REMOVAL AND SURFACE COVER REMEDY
FORMER KOPPERS WOOD-TREATING SITE
CARBONDALE, IL

DRAWN BY	K. KLIPPSTEIN	APPROVED BY	T. MORAN	REV	0	SHEET NO.
DATE	1/09/2021	DATE		PROJECT NO.	E8658	2 OF 2

Beazer East, Inc.
Soil Removal and Surface Cover Remedial Design
Former Koppers Wood-Treating Site
Carbondale, Illinois

