

Beazer East, Inc.

Former Koppers Wood-Treating Site – Carbondale, Illinois

Soil Removal and Surface Cover Remediation Project

Weekly Report #11: 12/28/20 – 1/3/21



**Soil Removal and Surface Cover
Former Koppers Wood-Treating Site
Carbondale, IL**

WEEKLY PROGRESS REPORT

Reporting Period: Monday, December 28th, 2020 to Sunday, January 3rd, 2021

Progress Meeting Date: None

1.0 Weather Conditions

Date	Conditions	Wind	Precipitation (in)
Monday 12/28/20	Partly Cloudy, 25-44 °F	9.6/NNW	0
Tuesday 12/29/20	Partly Cloudy, 25-44 °F	8.7/ESE	0
Wednesday 12/30/20	Rain, 33-54 °F	9.4/SSW	1.25
Thursday 12/31/20	Overcast, 29-33 °F	6.9/NNE	Trace
Friday 1/1/21	Not On-Site		0.39
Saturday 1/2/21	Partly Cloudy, 33-40 °F	2.2/NW	0
Sunday 1/3/21	Sunny, 28-51°F	5.4/WNW	0
Week Total			1.64
Site Cumulative			10.63

2.0 Health & Safety

Manhours Completed this Period: 525.5

Manhours Completed to Date: 5913

Notes

Day	Tailgate Topic(s)
Monday	COVID-19 protocols and refamiliarization with job tasks
Tuesday	Stop work authority
Wednesday	Personal health and hygiene
Thursday	PPE requirements and inspections
Friday	-
Saturday	Inspection of small hand tools, electrical wires, and lifting straps
Sunday	Using the proper tool for each task

3.0 ENTACT Work Activities Summary

Monday – December 28, 2020
Completed excavation of the northwestern corner of Soil Removal Area 1 and stockpiled material for load out in Soil Removal Area 3. Continued placement of general fill/vegetative cover and fine grading in Surface Cover Areas 2 and 3. Began construction of an access road to Surface Cover Area 1.
Tuesday – December 29, 2020
Placed geotextile and general fill/vegetative cover in the remaining excavated portion of Soil Removal Area 1. Continued placement of general fill/vegetative cover and fine grading in Surface Cover Area 2, with additional fill being stockpiled for future placement.
Wednesday – December 30, 2020
The site was too saturated from rain for placement of general fill/vegetative cover soil. Continued construction of an access road to Surface Cover Area 1 and placed a mat road over wetland areas.
Thursday – December 31, 2020
The site was too saturated from the previous rain event for placement of general fill/vegetative cover soil. Non-contact surface rainwater was pumped to an on-site location outside of the work areas for infiltration. Began excavation of impacted soil in Soil Removal Area 3 and stockpiled material for load out.
Friday – January 1, 2021
Not On-Site
Saturday – January 2, 2021
Continued pumping non-contact surface rainwater to an on-site location outside of the work areas for infiltration. Began excavation of impacted soil in Soil Removal Area 4 and stockpiled material for load out.
Sunday – January 3, 2021
Continued pumping non-contact surface rainwater to an on-site location outside of the work areas for infiltration. Continued excavation of impacted soil in Soil Removal Area 3 and stockpiled material for load out.

4.0 ENTACT Subcontractors

Date	Subcontractor/Vendor/ Third Party	Work Activity
12/31/2020	Shawnee Professional Services	Surveyed Surface Cover Area 1 prepared subgrade

5.0 ENTACT Deliveries

Material Import – Current Week		
Date	Description	Quantity
12/28/2020	General Fill/Vegetative Cover	2035 tons
12/28/2020	Riprap-1	98.37 tons
12/29/2020	General Fill/Vegetative Cover	2288 tons
12/29/2020	CA-2	23.71 tons
12/30/2020	CA-2	300.51 tons

Material Import – To Date	
Description	Quantity
General Fill	23887.60 tons
General Fill/Vegetative Cover	17716.83 tons
CA-2	2301.65 tons
Demarcation Fabric	747000 SF
Filter Sock	10230 LF
RipRap-1	231.74 tons

6.0 Material Export

No material export this week.

Material Export – To Date	
Description	Quantity
Impacted Soils	22551.85 tons

7.0 Construction Quality Control

See Attached Reports and Logs:

- Progress Photos
- Progress Map
- Current Project Schedule

8.0 Request for Information (RFIs)

- RFI 001 – Stabilized Construction Entrance Aggregate (Approved)
- None pending

9.0 Change in Conditions

- Borrow material from Shawnee Sand and Gravel corresponding to samples GF-03 and GF-04 was approved for use as both General Fill and Vegetative Cover Soil (per Submittal 019A). Previously, borrow material from Shawnee Sand and Gravel corresponding to sample GF-02 was approved for use as General Fill only (per Submittal 011).

Picture Number	1	
Date	12/28	
Direction	NW	
Description: Excavation of Soil Removal Area 1 in the North West corner.		
Picture Number	2	
Date	12/29	
Direction	SW	
Description: Final Grade general fill/ vegetative cover soil placed in Surface Cover 2.		
Picture Number	3	
Date	12/31	
Direction	S	
Description: Access road constructed to northern end of Surface Cover Area 1.		

Picture Number	4	
Date	1/02	
Direction	SW	
Description:	Excavation of Soil Removal Area 4.	

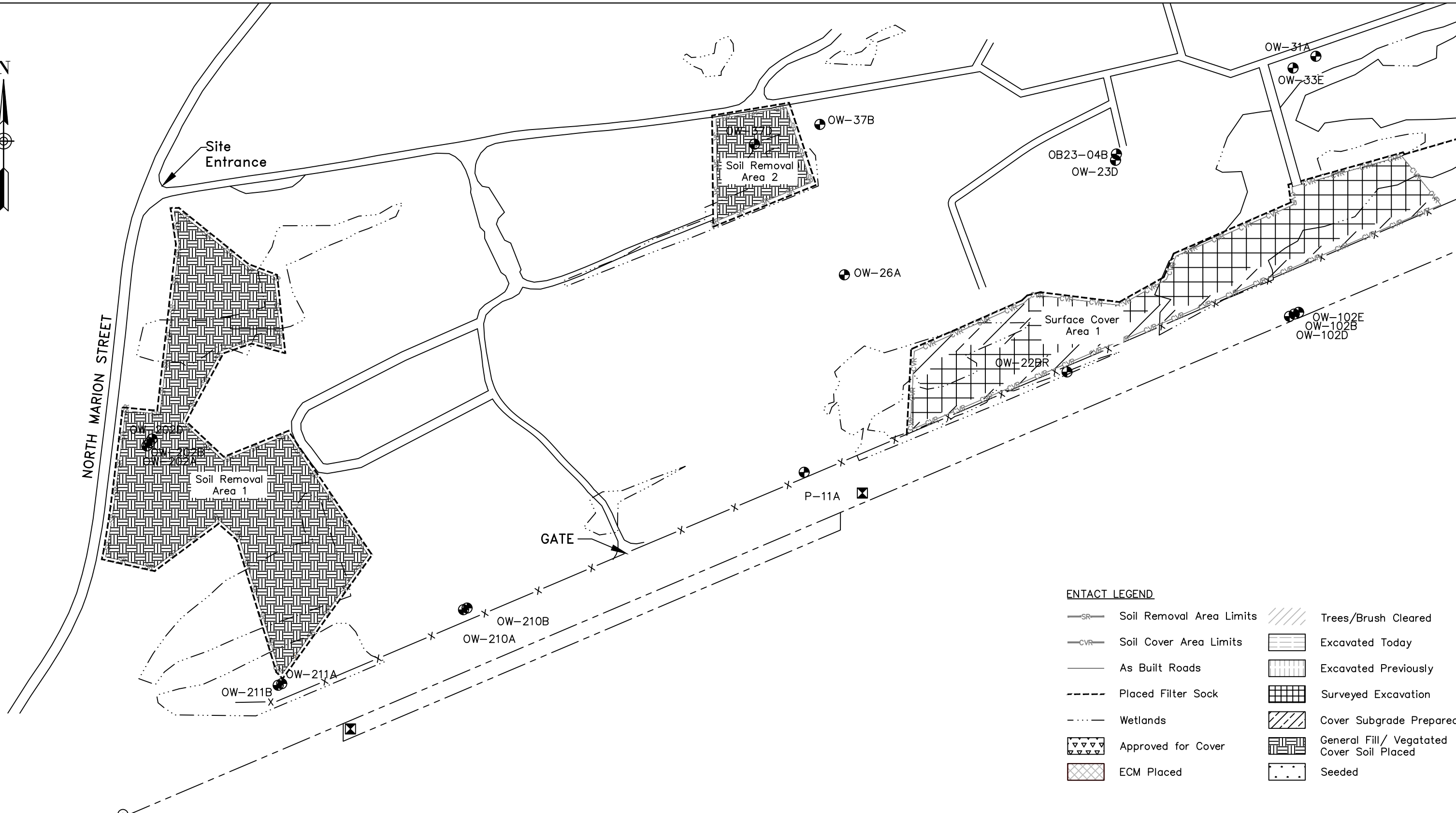

ENTACT LEGEND

Soil Removal Area Limits	Trees/Brush Cleared
Soil Cover Area Limits	Excavated Today
As Built Roads	Excavated Previously
Placed Filter Sock	Surveyed Excavation
Wetlands	Cover Subgrade Prepared
Approved for Cover	General Fill/ Vegetated Cover Soil Placed
ECM Placed	Seeded

REV	DATE	BY	CHK'D	APR'VD	DESCRIPTION

PREPARED FOR:
BEAZER EAST
PITTSBURGH, PA

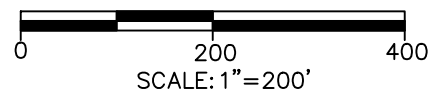

DRAWING NAME						Daily Progress Figure - Site West					
PROJECT NAME & LOCATION						SOIL REMOVAL AND SURFACE COVER REMEDY FORMER KOPPERS WOOD-TREATING SITE CARBONDALE, IL					
DRAWN BY	K. KLIPPSTEIN	APPROVED BY	T. MORAN	REV	0	SHEET NO.					
DATE	1/03/2021	DATE		PROJECT NO.	E8658	1 OF 2					

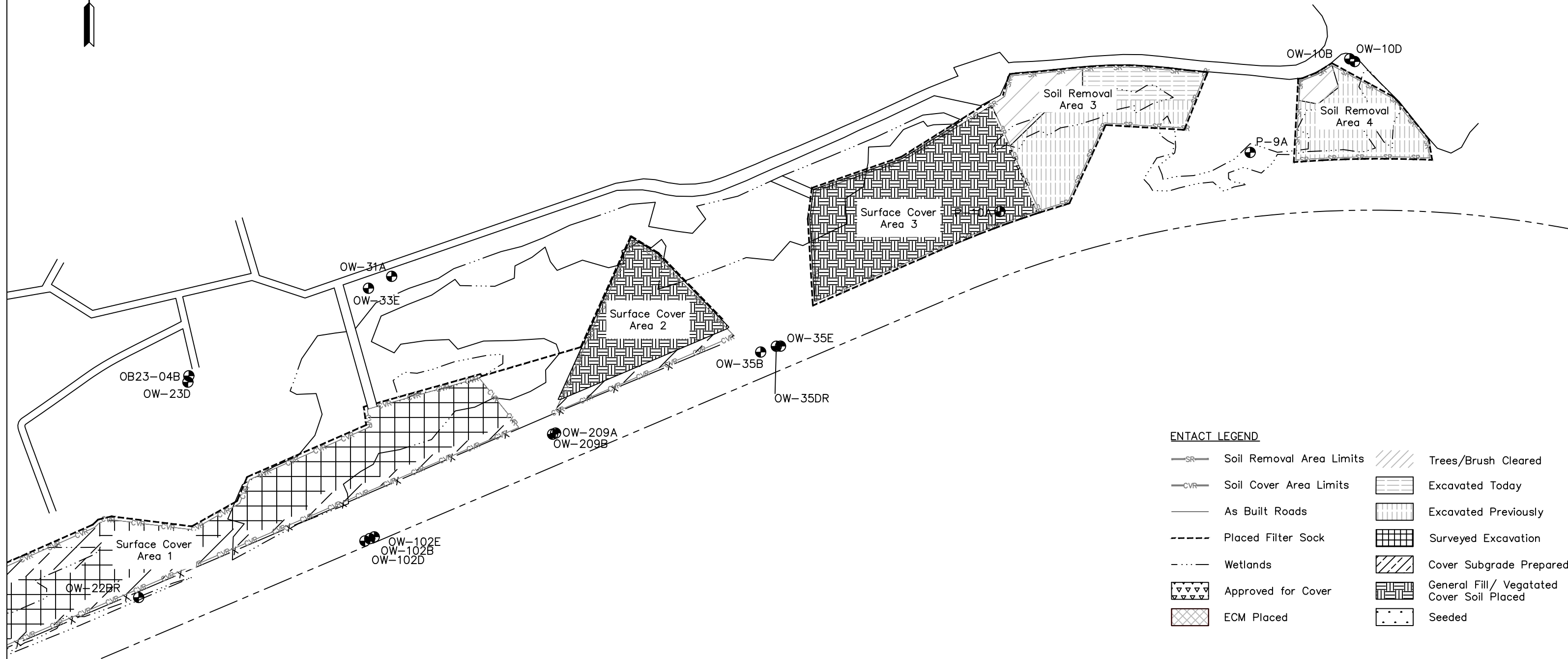

ENTACT LEGEND

- SR— Soil Removal Area Limits
- CVR— Soil Cover Area Limits
- As Built Roads
- - - - Placed Filter Sock
- · - · - Wetlands
- ▽▽▽▽ Approved for Cover
- ⊠ ECM Placed
- /// Trees/Brush Cleared
- ▨ Excavated Today
- ▩ Excavated Previously
- ▧ Surveyed Excavation
- ▨ Cover Subgrade Prepared
- ▩ General Fill/ Vegetated Cover Soil Placed
- · · Seeded

REV	DATE	BY	CHK'D	APR'VD	DESCRIPTION

PREPARED FOR:
BEAZER EAST
PITTSBURGH, PA

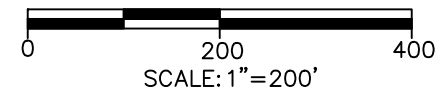

DRAWING NAME						Daily Progress Figure - Site East					
PROJECT NAME & LOCATION						SOIL REMOVAL AND SURFACE COVER REMEDY FORMER KOPPERS WOOD-TREATING SITE CARBONDALE, IL					
DRAWN BY	K. KLIPPSTEIN	APPROVED BY	T. MORAN	REV	0	SHEET NO.					
DATE	1/03/2021	DATE		PROJECT NO.	E8658	2 OF 2					

Beazer East, Inc.
Soil Removal and Surface Cover Remedial Design
Former Koppers Wood-Treating Site
Carbondale, Illinois



ENTACT PROJECT SCHEDULE Summary Task Milestone Progress
 Date: Mon 1/4/21