



AECOM
100 S. Wacker Drive, Suite 500
Chicago, Illinois 60606

312-939-1000 tel
312-939-4198 fax

October 13, 2016

Mike Jouras
Peoples Gas Light & Coke Co.
Environmental Services Department
200 E. Randolph Street, 24th Floor
Chicago, IL 60601

RE: Radiological Survey of a Utility Service Relocation
Permit No.: DOT698102
Permit Address: 301-40 N. Field Blvd., Chicago, Illinois
AECOM Project No. 60157647.76

Dear Mr. Jouras:

Pursuant to conditions specified in a permit (see attached) issued by the City of Chicago, radiation monitoring was required to be performed at the above referenced site. AECOM Technical Services, Inc. (AECOM) provided the required radiation surveillance between September 15 and October 12, 2016 for excavation related to relocation a utility service line.

Surveying was performed within the excavations and on the spoil removed at 301-40 N. Field Blvd. (refer to sketch). The excavation was composed of three trenches; two of the trenches within N. Field Blvd and one trench near the intersection of Sub-Lower Wacker Drive and N. Field Blvd. The two separate trenches within N. Field Blvd. were approximately 140-feet and 60-feet in length with varying depths of 36 to 114-inches below ground surface (bgs). The trench near the intersection of N. Field Blvd. and Lower-Lower Wacker Dr. was approximately 6-feet wide by 12-feet long, to a depth of 3-feet bgs.

The monitoring did not indicate that the fill soils were above the removal action level established by the U.S. Environmental Protection Agency (USEPA) for the Streeterville area of Chicago. The USEPA removal action level for Chicago's Streeterville area is 7.1 picocuries per gram (pCi/g) total radium (Ra-226 + Ra-228). Gamma radiation count measurements for the project were recorded using Ludlum Models 2221 survey meter and an unshielded 2 x 2 inch NaI probe (Model 44-10). For the instrument used, the gamma count threshold indicative of the 7.1 pCi/g removal action level is 17,253 (S/N: 172039) counts per minute (cpm) unshielded.

The field gamma measurements within the excavations and of the spoil during the excavation process did not exceed the instrument threshold previously stated and predominantly ranged from a minimum of 3,000 cpm to a maximum of 10,000 cpm unshielded. A few anomalous readings were recorded within the western trench of N. Field Blvd., with trench readings up to 14,300. Based on field observations there was no indication of the presence of radiologically-contaminated fill and/or an exceedance of the USEPA removal action level of 7.1 pCi/g total radium. A copy of the permit and a field sketch documenting the area where work was performed, have been included as attachments.

As part of the permit conditions, this letter has been forwarded to:

Chicago Department of Public Health
Attention: Ms. Rahmat Begum
333 South State Street, Room 200
Chicago, Illinois 60604

Permit No.: DOT698102
Permit Address: 301-40 N. Field Blvd.
Page 2

Please contact us with any questions you have regarding this letter or the reported results.

Regards,



Andrew Kozak
Geologist



Steven C. Kornder, Ph.D.
Senior Project Geochemist

cc: Rahmat Begum, Chicago Department of Public Health
Verneta Simon, USEPA

Attachments: Permit
Sketch

PERMIT



DEPARTMENT OF PUBLIC HEALTH
CITY OF CHICAGO

FORM NO. CDPH.ROW.03 (STREETERVILLE Right-of-Way)

Notice is hereby given that the site you have requested a permit for is recorded with the City of Chicago Department of Public Health (CDPH) as potentially having environmental contamination on the site and adjacent right-of-way. This environmental contamination could present a threat to human health and safety in connection with work performed at the site, or in the adjacent right-of-way, if proper safeguards are not employed.

A file containing detailed information regarding the aforementioned environmental contamination is available for review at CDPH at 333 S. State St., Room 200, Chicago, Illinois 60604 during normal business hours (8:30AM-4:30PM, Monday through Friday). Contact (312) 745-3152 for an appointment. This file must be reviewed and the remainder of this form completed before the permit can be issued if the ground is exposed or excavated. Please note that for some locations, additional health and safety procedures may be required by law.

Please complete the following:

I have reviewed and understand the documents, maintained by CDPH, regarding environmental contamination of the site and adjacent right-of-way. Further, I will ensure that all work at the subject site and adjacent right-of-way, and any monitoring required including but not limited to radiation monitoring, will be performed in a manner that is protective of human health and the environment and in compliance with all applicable local, state, and federal laws, rules, and regulations, especially those pertaining to worker safety and waste management. I will ensure that the results of any radiation monitoring and/or surveying conducted shall be provided to the CDPH and the United States Environmental Protection Agency within two (2) weeks of their completion. If any elevated levels of radioactive material are detected, I will immediately contact the United States Environmental Protection Agency at (800) 424-8802.

Applicant Name (print): Maria G. Oliver Signature: Maria G. Oliver

Site Address and Work Location (Describe exact site location and attach map): _____

301-40 N. Field Blvd.

Nature of Work: Gas Main Installation

Company Name, Address, Phone No.: Peoples Gas, 200 E. Randolph (312) 240-4692

General / Prime Contractor Name, Address, Phone No.: Mike Crosby (708) 243-7802

Include subcontractor information if applicable

Safety Officer / Phone No. Gerry Gross (773) 542-7927

Radiation Contractor / Phone No. (if applicable) Steve Konder, AECOM, Inc. (362) 515-7700

Check if City Department Work Department Name: _____

CDOT Permit No.: DOT698102

Today's Date: 9/6/16 Expected Start Date: 9/12/16 CDPH Approval / Date: J Sheahan 9/7/16

Please return this completed form to the Chicago Department of Transportation, Division of Infrastructure Management, Public Way Permit Office, City Hall - Room 905, 121 N. LaSalle St., Chicago, Illinois 60602 during normal business hours (8:30 AM - 4:30 PM, Monday through Friday)

For CDPH Use Only

INDEX OF SHEETS

DRAWING NO.	SHEET NO.	SHEET TITLE
C1	1	TITLE SHEET
C2	2	SIGNATURES AND SEALS
C3	3	GENERAL NOTES
C4	4	SYMBOLS AND SPECIFICATIONS
C5-C5A	5-6	INSTALLATION PLAN & PROFILES
RET1	7	RETIREMENT PLAN
R1	8	RESTORATION PLAN
R2	9	RESTORATION DETAILS
T1-T4	10-13	TRAFFIC CONTROL PLAN
T5-T6	14-15	TRAFFIC CONTROL STANDARDS

**CENTRAL SHOP
C-WANDA-01-PI-CN03189
PROPOSED 16" GAS MAIN
INSTALLATION & RETIREMENT**

PROJECT DESCRIPTION AND SCOPE OF WORK:

INSTALL: 16" STMP GAS MAIN
RETIRE: 12" PLMP & 16" STMP GAS MAIN
LOCATION: N. FIELD BLVD. (E. SOUTH WATER ST. TO E. LOWER WACKER DR.)

STANDARDS

CDOT RULES & REGULATIONS FOR CONSTRUCTION IN THE PUBLIC WAY

CHAPTER 4.1.12 - EROSION & SITE CLEANLINESS

APPENDIX B - ADA STANDARDS

IDOT HIGHWAY STANDARDS #

- 701501-06
- 701701-10
- 701801-06
- 701901-05

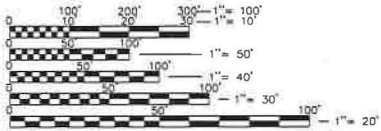

FULL SIZE PLANS HAVE BEEN PREPARED USING STANDARD ENGINEERING SCALES. REDUCED SIZED PLANS WILL NOT CONFORM TO STANDARD SCALES. IN MAKING MEASUREMENTS ON REDUCED PLANS, THE ABOVE SCALES MAY BE USED.

DIGGER: 312-744-7000
CONTRACTOR SHALL CALL DIGGER TWO (2) WORKING DAYS (48 HOURS) BEFORE DIGGING.

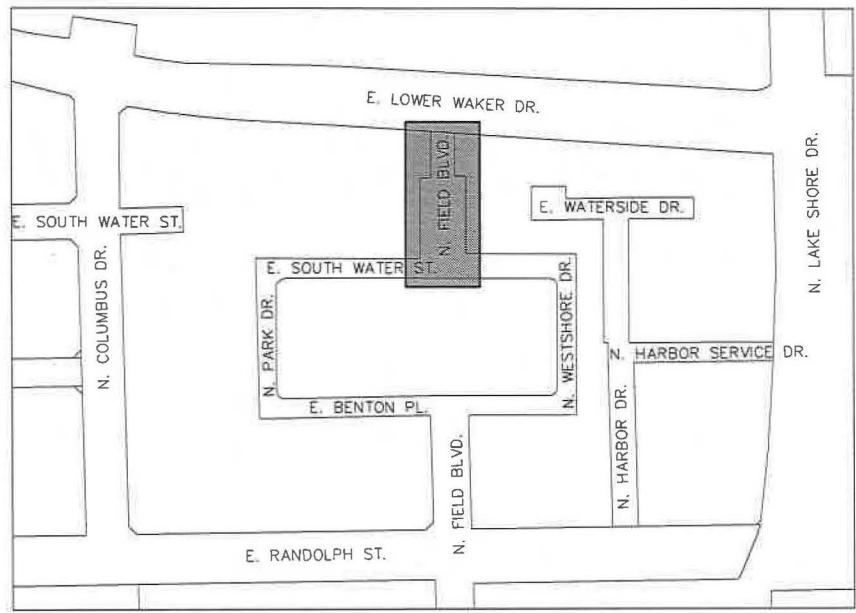

LOCATION MAP (N.T.S.)

NOTE: APPROX. 77 FT. OF 12" PLMP GAS MAIN REQUIRE APPROX. 230 FT. OF 16" STMP GAS MAIN
NUMBER OF ADA RAMP REPLACEMENTS = 0

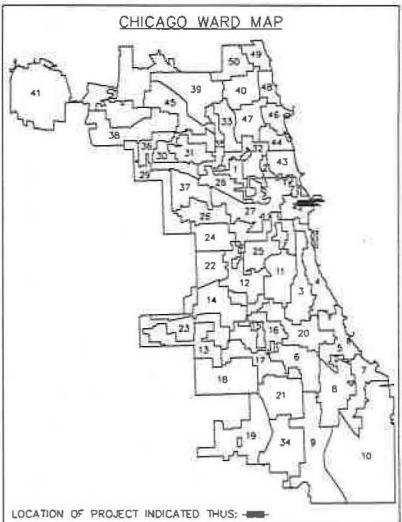

GAS MAIN RETIREMENT & 16" GAS MAIN INSTALLATION

NOTE: THIS PLAN IS TO BE USED FOR THE PROPOSED 16" GAS MAIN INSTALLATION AND RETIREMENT. IT IS NOT TO BE USED FOR ANY OTHER PURPOSES. THE CONTRACTOR SHALL BE RESPONSIBLE FOR OBTAINING ALL NECESSARY PERMITS AND APPROVALS FROM THE CITY OF CHICAGO AND THE ILLINOIS STATE BOARD OF CONSTRUCTION.

REVISION NO.	BY NO.	DATE	SHEET NO.	STATUS

ENGINEERING CONSULTANT:
BE Engineering
28100 TOWNE PARKWAY
MERRILLVILLE, IN 46390
TEL: 317-833-7999
WWW.BEENGINEERING.COM

DESIGNED BY: LD	DATE: 07-14-2016	REV	DATE	BY	SHEETS
DRAWN BY: JR					
CHECKED BY: LD					
SCALE: N.T.S.					

PEOPLES GAS
NATURAL GAS DELIVERY

CENTRAL SHOP
C-WANDA-01-PI-CN03189
PROPOSED 16" GAS MAIN
INSTALLATION & RETIREMENT
TITLE SHEET

DP PROJECT NUMBER	NON-DP PROJECT NUMBER	0017016063
DP BCA NUMBER	NON-DP BCA NUMBER	3199
DP WR NUMBER	NON-DP WR NUMBER	2199521
DUC NUMBER	DRAWING NO.	C1
2016-21792	SHEET NO.	1 OF 15

CHICAGO, IL 60604

SKETCH

Equipment

Lucium 2221 S/N: 172039
 Probe 2x2 NaI S/N: 174496
 unshielded: 17,253 cpm
 shielded: 7,018 cpm
 background: 8,400 cpm
 personnel: A. Kozak

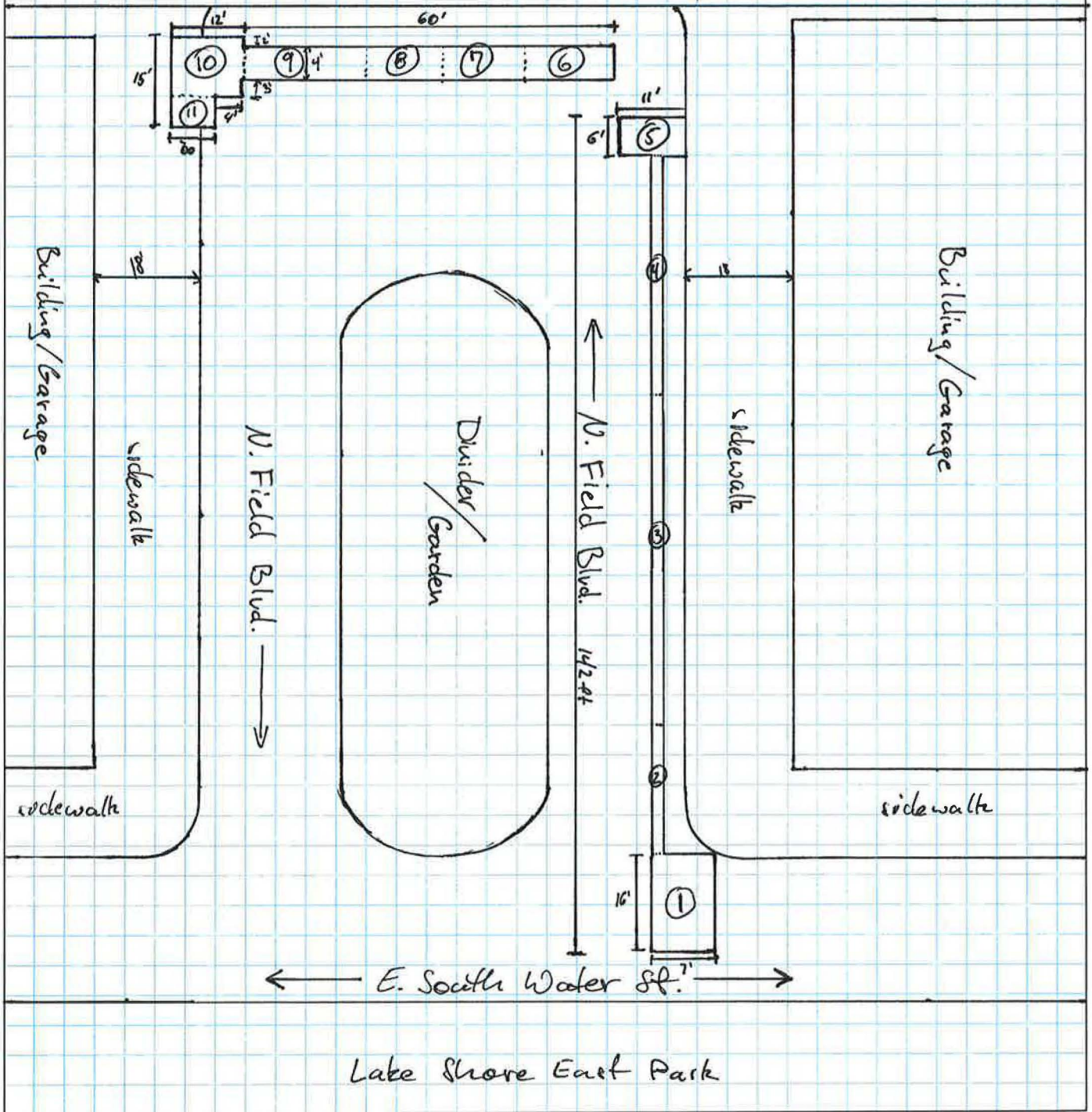

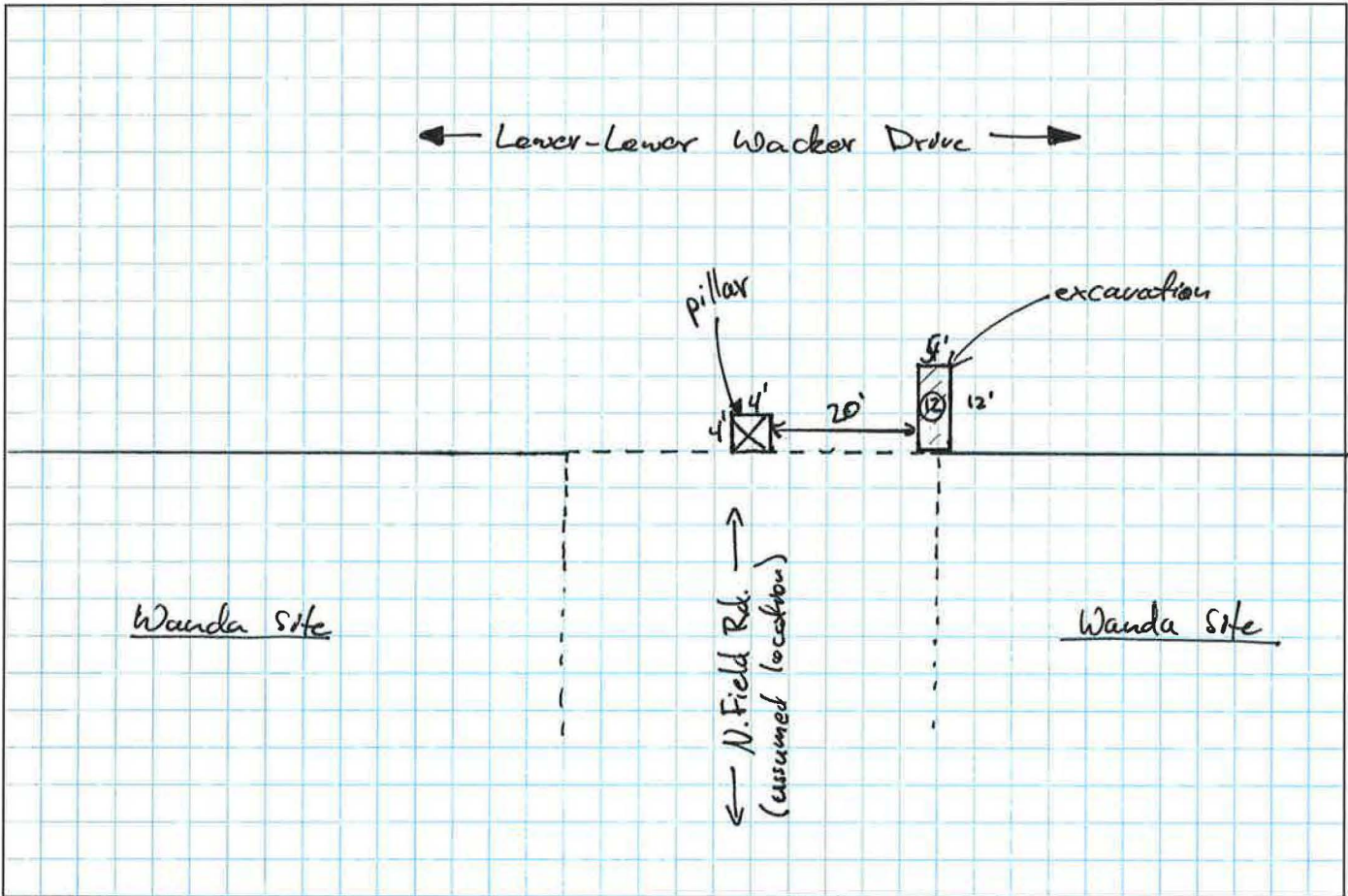

Readings (surface reading not recorded as it was asphalt)

Depth	CPM	Depth	CPM
① surface	—	⑦ 16"	4,000 - 5,100
16" (beneath concrete)	6,400 - 7,200	16"-48" (spoil)	3,600 - 4,800
30"	5,500 - 8,600	48"-102"	8,500 - 9,200
45"	6,500 - 9,200	102" (floor)	8,700 - 9,700
45"-69" (spoil)	3,400 - 5,000	⑧ 16"	3,600 - 5,000
② 16"	5,600 - 6,400	16"-48"	4,700 - 6,000
16"-45" (spoil)	7,200 - 8,700	48"-102"	4,100 - 7,000
③ 16"	5,000 - 5,600	102" (floor)	7,400 - 8,700
36" (stone)	4,400 - 6,400	⑨ 16"	3,000 - 4,800
④ 16"	4,400 - 6,000	16"-48"	6,200 - 7,100
16"-36"	8,100 - 10,700	68"	8,600 - 9,700
⑤ 16"	5,400 - 6,400	84"	10,200 - 10,600
16"-60" (spoil)	4,700 - 6,000	102"	11,100 - 11,700
⑥ 16"	3,200 - 4,400	⑩ 16"-60" (sand)	4,300 - 5,300
16"-48"	4,000 - 5,100	78"	11,200 - 13,400
48"-102"	6,000 - 7,700	96"	10,700 - 12,400
102"	8,800 - 10,900	114"	12,000 - 14,300
		⑪ 16"-102" (spoil/sand)	4,400 - 7,600
		⑫ 16"-54" (spoil/sand)	3,600 - 5,800