



United States Environmental Protection Agency
Washington, DC 20460

ANNUAL DISPOSAL/INJECTION WELL MONITORING REPORT

Name and Address of Existing Permittee USC Saltville Brine, LLC 4800 San Felipe, Houston, TX 77056	Name and Address of Surface Owner USC Saltville Brine, LLC 4800 San Felipe, Houston, TX 77056
----------------------------------------------------------------------------------------------------------	-----------------------------------------------------------------------------------------------------

Locate Well and Outline Unit on Section Plat - 640 Acres 	State Virginia	County Smyth/Washington	Permit Number VAS3G931BSMY
Surface Location Description 1/4 of 1/4 of 1/4 of 1/4 of Section Township Range			
Locate well in two directions from nearest lines of quarter section and drilling unit Surface Location _____ ft. frm (N/S) _____ Line of quarter section and _____ ft. from (E/W) _____ Line of quarter section.			
WELL ACTIVITY <input type="checkbox"/> Brine Disposal <input type="checkbox"/> Enhanced Recovery <input type="checkbox"/> Hydrocarbon Storage		TYPE OF PERMIT <input type="checkbox"/> Individual <input checked="" type="checkbox"/> Area Number of Wells <u>17</u>	
Lease Name <u>Saltville</u>		Well Number <u>#17</u>	

MONTH	YEAR	INJECTION PRESSURE		TOTAL VOLUME INJECTED		TUBING -- CASING ANNULUS PRESSURE (OPTIONAL MONITORING)	
		AVERAGE PSIG	MAXIMUM PSIG	BBL	MCF	MINIMUM PSIG	MAXIMUM PSIG
January-2022		330	330	0			
February-2022		330	330	0			
March-2022		330	330	0			
April-2022		330	330	0			
May-2022		330	330	0			
June-2022		330	330	0			

Certification

I certify under the penalty of law that I have personally examined and am familiar with the information submitted in this document and all attachments and that, based on my inquiry of those individuals immediately responsible for obtaining the information, I believe that the information is true, accurate, and complete. I am aware that there are significant penalties for submitting false information, including the possibility of fine and imprisonment. (Ref. 40 CFR 144.32)

Name and Official Title (Please type or print) Derek Snodgrass, Brine Production Operator	Signature 	Date Signed 07/05/22
----------------------------------------------------------------------------------------------	---------------	-------------------------



United States Environmental Protection Agency
Washington, DC 20460

ANNUAL DISPOSAL/INJECTION WELL MONITORING REPORT

Name and Address of Existing Permittee USC Saltville Brine, LLC 4800 San Felipe, Houston, TX 77056	Name and Address of Surface Owner USC Saltville Brine, LLC 4800 San Felipe, Houston, TX 77056
----------------------------------------------------------------------------------------------------------	-----------------------------------------------------------------------------------------------------

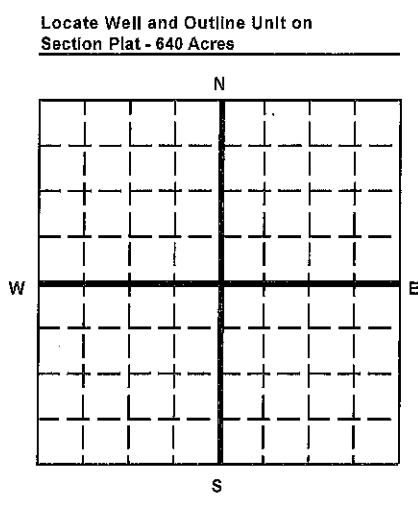

State Virginia	County Smyth/Washington	Permit Number VAS3G931BSMY
Surface Location Description 1/4 of 1/4 of 1/4 of 1/4 of Section Township Range		
Locate well in two directions from nearest lines of quarter section and drilling unit Surface Location: ft. frm (N/S) Line of quarter section and: ft. from (E/W) Line of quarter section.		
WELL ACTIVITY <input type="checkbox"/> Brine Disposal <input type="checkbox"/> Enhanced Recovery <input type="checkbox"/> Hydrocarbon Storage		TYPE OF PERMIT <input type="checkbox"/> Individual <input checked="" type="checkbox"/> Area Number of Wells: 17
Lease Name: Saltville		Well Number: #9

MONTH	YEAR	INJECTION PRESSURE		TOTAL VOLUME INJECTED		TUBING -- CASING ANNULUS PRESSURE (OPTIONAL MONITORING)	
		AVERAGE PSIG	MAXIMUM PSIG	BBL	MCF	MINIMUM PSIG	MAXIMUM PSIG
January-2022		410	410	0			
February-2022		410	410	0			
March-2022		410	410	0			
April-2022		410	410	0			
May-2022		410	410	0			
June-2022		410	410	0			

Certification

I certify under the penalty of law that I have personally examined and am familiar with the information submitted in this document and all attachments and that, based on my inquiry of those individuals immediately responsible for obtaining the information, I believe that the information is true, accurate, and complete. I am aware that there are significant penalties for submitting false information, including the possibility of fine and imprisonment. (Ref. 40 CFR 144.32)

Name and Official Title (Please type or print) Derek Snodgrass, Brine Production Operator	Signature 	Date Signed 07/05/22
----------------------------------------------------------------------------------------------	---------------	-------------------------



United States Environmental Protection Agency
Washington, DC 20460

ANNUAL DISPOSAL/INJECTION WELL MONITORING REPORT

Name and Address of Existing Permittee

USC Saltville Brine, LLC
4800 San Felipe, Houston, TX 77056

Name and Address of Surface Owner

USC Saltville Brine, LLC
4800 San Felipe, Houston, TX 77056

Locate Well and Outline Unit on
Section Plat - 640 Acres

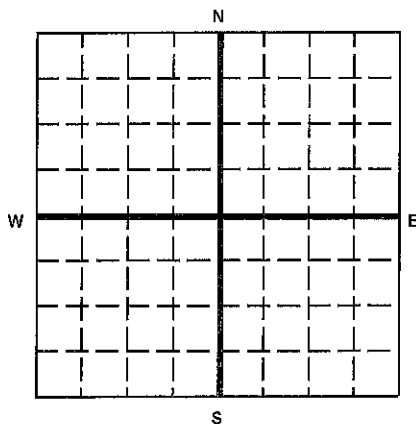

State Virginia County Smyth/Washington Permit Number VAS3G931BSMY

Surface Location Description
 ___ 1/4 of ___ 1/4 of ___ 1/4 of ___ 1/4 of Section ___ Township ___ Range ___

Locate well in two directions from nearest lines of quarter section and drilling unit

Surface Location ___ ft. frm (N/S) ___ Line of quarter section
 and ___ ft. from (E/W) ___ Line of quarter section.

WELL ACTIVITY TYPE OF PERMIT
 Brine Disposal Individual
 Enhanced Recovery Area
 Hydrocarbon Storage Number of Wells 17

Lease Name Saltville Well Number #15

INJECTION PRESSURE

TOTAL VOLUME INJECTED

TUBING -- CASING ANNULUS PRESSURE
(OPTIONAL MONITORING)

MONTH	YEAR	AVERAGE PSIG	MAXIMUM PSIG	BBL	MCF	MINIMUM PSIG	MAXIMUM PSIG
January-2022		200	200	0			
February-2022		200	200	0			
March-2022		200	200	0			
April-2022		200	200	0			
May-2022		200	200	0			
June-2022		200	200	0			

Certification

I certify under the penalty of law that I have personally examined and am familiar with the information submitted in this document and all attachments and that, based on my inquiry of those individuals immediately responsible for obtaining the information, I believe that the information is true, accurate, and complete. I am aware that there are significant penalties for submitting false information, including the possibility of fine and imprisonment. (Ref. 40 CFR 144.32)

Name and Official Title (Please type or print)
 Derek Snodgrass, Brine Production Operator

Signature

Date Signed
 07/05/22



United States Environmental Protection Agency
Washington, DC 20460

ANNUAL DISPOSAL/INJECTION WELL MONITORING REPORT

Name and Address of Existing Permittee
USC Saltville Brine, LLC
4800 San Felipe, Houston, TX 77056

Name and Address of Surface Owner
USC Saltville Brine, LLC
4800 San Felipe, Houston, TX 77056

Locate Well and Outline Unit on
Section Plat - 640 Acres

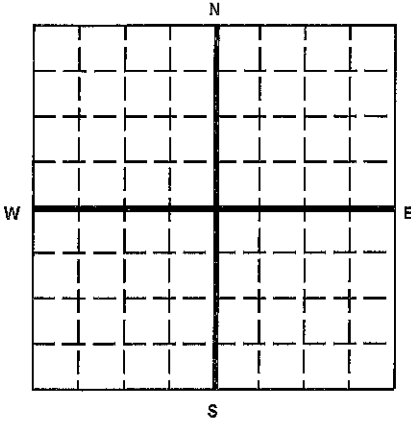

State Virginia	County Smyth/Washington	Permit Number VAS3G931BSMY
Surface Location Description 1/4 of 1/4 of 1/4 of 1/4 of Section ___ Township ___ Range ___		
Locate well in two directions from nearest lines of quarter section and drilling unit Surface Location: ___ ft. frm (N/S) ___ Line of quarter section and: ___ ft. from (E/W) ___ Line of quarter section.		
WELL ACTIVITY <input type="checkbox"/> Brine Disposal <input type="checkbox"/> Enhanced Recovery <input type="checkbox"/> Hydrocarbon Storage	TYPE OF PERMIT <input type="checkbox"/> Individual <input checked="" type="checkbox"/> Area Number of Wells <u>17</u>	
Lease Name: Saltville		Well Number: #13B

MONTH	YEAR	INJECTION PRESSURE		TOTAL VOLUME INJECTED		TUBING -- CASING ANNULUS PRESSURE (OPTIONAL MONITORING)	
		AVERAGE PSIG	MAXIMUM PSIG	BBL	MCF	MINIMUM PSIG	MAXIMUM PSIG
January-2022		200	200	0			
February-2022		200	200	0			
March-2022		200	200	0			
April-2022		200	200	0			
May-2022		200	200	0			
June-2022		200	200	0			

Certification

I certify under the penalty of law that I have personally examined and am familiar with the information submitted in this document and all attachments and that, based on my inquiry of those individuals immediately responsible for obtaining the information, I believe that the information is true, accurate, and complete. I am aware that there are significant penalties for submitting false information, including the possibility of fine and imprisonment. (Ref. 40 CFR 144.32)

Name and Official Title (Please type or print) Derek Snodgrass, Brine Production Operator	Signature 	Date Signed 07/05/22
----------------------------------------------------------------------------------------------	---------------	-------------------------



United States Environmental Protection Agency
Washington, DC 20460

ANNUAL DISPOSAL/INJECTION WELL MONITORING REPORT

Name and Address of Existing Permittee USC Saltville Brine, LLC 4800 San Felipe, Houston, TX 77056	Name and Address of Surface Owner USC Saltville Brine, LLC 4800 San Felipe, Houston, TX 77056
----------------------------------------------------------------------------------------------------------	-----------------------------------------------------------------------------------------------------

Locate Well and Outline Unit on Section Plat - 640 Acres

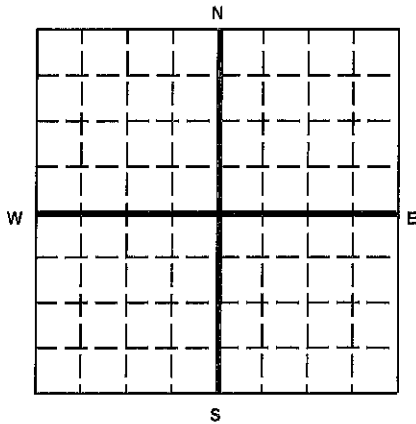

State Virginia	County Smyth/Washington	Permit Number VAS3G931BSMY
Surface Location Description 1/4 of 1/4 of 1/4 of 1/4 of Section Township Range		
Locate well in two directions from nearest lines of quarter section and drilling unit Surface Location: ft. frm (N/S) Line of quarter section and: ft. from (E/W) Line of quarter section.		
WELL ACTIVITY <input type="checkbox"/> Brine Disposal <input type="checkbox"/> Enhanced Recovery <input type="checkbox"/> Hydrocarbon Storage	TYPE OF PERMIT <input type="checkbox"/> Individual <input checked="" type="checkbox"/> Area Number of Wells: 17	
Lease Name: Saltville		Well Number: #14A

MONTH	YEAR	INJECTION PRESSURE		TOTAL VOLUME INJECTED		TUBING -- CASING ANNULUS PRESSURE (OPTIONAL MONITORING)	
		AVERAGE PSIG	MAXIMUM PSIG	BBL	MCF	MINIMUM PSIG	MAXIMUM PSIG
January-2022		200	200	0			
February-2022		200	200	0			
March-2022		200	200	0			
April-2022		200	200	0			
May-2022		200	200	0			
June-2022		200	200	0			

Certification

I certify under the penalty of law that I have personally examined and am familiar with the information submitted in this document and all attachments and that, based on my inquiry of those individuals immediately responsible for obtaining the information, I believe that the information is true, accurate, and complete. I am aware that there are significant penalties for submitting false information, including the possibility of fine and imprisonment. (Ref. 40 CFR 144.32)

Name and Official Title (Please type or print) Derek Snodgrass, Brine Production Operator	Signature 	Date Signed 07/05/22
----------------------------------------------------------------------------------------------	---------------	-------------------------



United States Environmental Protection Agency
Washington, DC 20460

ANNUAL DISPOSAL/INJECTION WELL MONITORING REPORT

Name and Address of Existing Permittee USC Saltville Brine, LLC 4800 San Felipe, Houston, TX 77056	Name and Address of Surface Owner USC Saltville Brine, LLC 4800 San Felipe, Houston, TX 77056
----------------------------------------------------------------------------------------------------------	-----------------------------------------------------------------------------------------------------

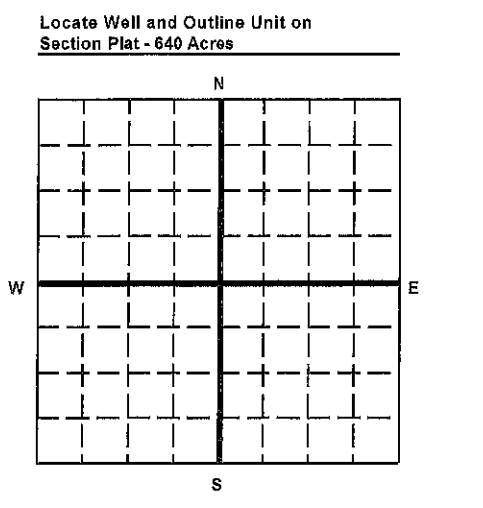

State Virginia	County Smyth/Washington	Permit Number VAS3G931BSMY
Surface Location Description 1/4 of 1/4 of 1/4 of 1/4 of Section Township Range		
Locate well in two directions from nearest lines of quarter section and drilling unit Surface Location: ft. frm (N/S) Line of quarter section and: ft. from (E/W) Line of quarter section.		
WELL ACTIVITY <input type="checkbox"/> Brine Disposal <input type="checkbox"/> Enhanced Recovery <input type="checkbox"/> Hydrocarbon Storage	TYPE OF PERMIT <input type="checkbox"/> Individual <input checked="" type="checkbox"/> Area Number of Wells: 17	
Lease Name: Saltville		Well Number: #3

MONTH	YEAR	INJECTION PRESSURE		TOTAL VOLUME INJECTED		TUBING -- CASING ANNULUS PRESSURE (OPTIONAL MONITORING)	
		AVERAGE PSIG	MAXIMUM PSIG	BBL	MCF	MINIMUM PSIG	MAXIMUM PSIG
January-2022		434	446	231500			
February-2022		444	548	222237			
March-2022		418	450	232563			
April-2022		406	431	218601			
May-2022		393	420	198476			
June-2022		436	443	204195			

Certification

I certify under the penalty of law that I have personally examined and am familiar with the information submitted in this document and all attachments and that, based on my inquiry of those individuals immediately responsible for obtaining the information, I believe that the information is true, accurate, and complete. I am aware that there are significant penalties for submitting false information, including the possibility of fine and Imprisonment. (Ref. 40 CFR 144.32)

Name and Official Title (Please type or print) Derek Snodgrass, Brine Production Operator	Signature 	Date Signed 07/05/22
----------------------------------------------------------------------------------------------	---------------	-------------------------



United States Environmental Protection Agency
Washington, DC 20460

ANNUAL DISPOSAL/INJECTION WELL MONITORING REPORT

Name and Address of Existing Permittee
USC Saltville Brine, LLC
4800 San Felipe, Houston, TX 77056

Name and Address of Surface Owner
USC Saltville Brine, LLC
4800 San Felipe, Houston, TX 77056

Locate Well and Outline Unit on
Section Plat - 640 Acres

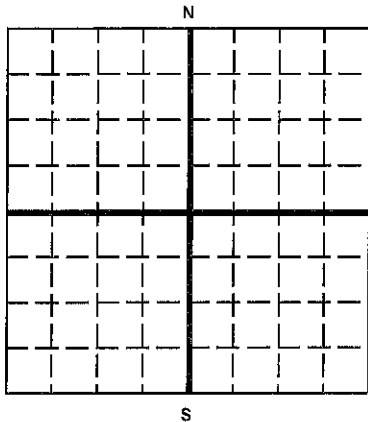

State Virginia County Smyth/Washington Permit Number VAS3G931BSMY

Surface Location Description
1/4 of 1/4 of 1/4 of 1/4 of Section Township Range

Locate well in two directions from nearest lines of quarter section and drilling unit

Surface Location ft. frm (N/S) Line of quarter section
and ft. from (E/W) Line of quarter section.

WELL ACTIVITY TYPE OF PERMIT
 Brine Disposal Individual
 Enhanced Recovery Area
 Hydrocarbon Storage Number of Wells 17

Lease Name Saltville Well Number #2

MONTH	YEAR	INJECTION PRESSURE		TOTAL VOLUME INJECTED		TUBING -- CASING ANNULUS PRESSURE (OPTIONAL MONITORING)	
		AVERAGE PSIG	MAXIMUM PSIG	BBL	MCF	MINIMUM PSIG	MAXIMUM PSIG
January-2022		81	84	0			
February-2022		85	89	0			
March-2022		83	89	0			
April-2022		83	89	0			
May-2022		79	84	0			
June-2022		82	84	0			

Certification

I certify under the penalty of law that I have personally examined and am familiar with the information submitted in this document and all attachments and that, based on my inquiry of those individuals immediately responsible for obtaining the information, I believe that the information is true, accurate, and complete. I am aware that there are significant penalties for submitting false information, including the possibility of fine and imprisonment. (Ref. 40 CFR 144.32)

Name and Official Title (Please type or print)
Derek Snodgrass, Brine Production Operator

Signature
Derek Snodgrass

Date Signed
07/05/22



United States Environmental Protection Agency
Washington, DC 20460

ANNUAL DISPOSAL/INJECTION WELL MONITORING REPORT

Name and Address of Existing Permittee USC Saltville Brine, LLC 4800 San Felipe, Houston, TX 77056	Name and Address of Surface Owner USC Saltville Brine, LLC 4800 San Felipe, Houston, TX 77056
-----------------------------------------------------------------------------------------------------------------	------------------------------------------------------------------------------------------------------------

Locate Well and Outline Unit on Section Plat - 640 Acres

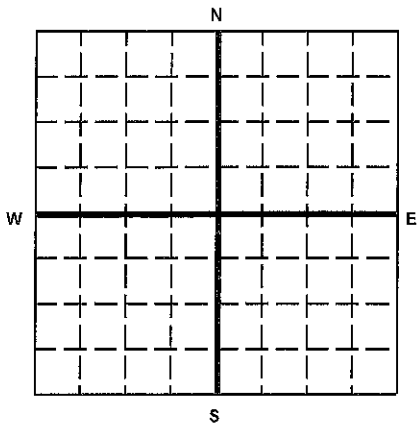

State Virginia	County Smyth/Washington	Permit Number VAS3G931BSMY
Surface Location Description 1/4 of 1/4 of 1/4 of 1/4 of Section Township Range		
Locate well in two directions from nearest lines of quarter section and drilling unit Surface Location: ft. frm (N/S) Line of quarter section and ft. from (E/W) Line of quarter section.		
WELL ACTIVITY <input type="checkbox"/> Brine Disposal <input type="checkbox"/> Enhanced Recovery <input type="checkbox"/> Hydrocarbon Storage		TYPE OF PERMIT <input type="checkbox"/> Individual <input checked="" type="checkbox"/> Area Number of Wells: 17
Lease Name: Saltville		Well Number: #4

MONTH	YEAR	INJECTION PRESSURE		TOTAL VOLUME INJECTED		TUBING -- CASING ANNULUS PRESSURE (OPTIONAL MONITORING)	
		AVERAGE PSIG	MAXIMUM PSIG	BBL	MCF	MINIMUM PSIG	MAXIMUM PSIG
January-2022		265	360	74607			
February-2022		265	437	60101			
March-2022		259	345	42239			
April-2022		255	277	10149			
May-2022		242	245	54533			
June-2022		264	269	58354			

Certification

I certify under the penalty of law that I have personally examined and am familiar with the information submitted in this document and all attachments and that, based on my inquiry of those individuals immediately responsible for obtaining the information, I believe that the information is true, accurate, and complete. I am aware that there are significant penalties for submitting false information, including the possibility of fine and imprisonment. (Ref. 40 CFR 144.32)

Name and Official Title (Please type or print) Derek Snodgrass, Brine Production Operator	Signature 	Date Signed 07/05/22
-----------------------------------------------------------------------------------------------------	----------------------	--------------------------------



United States Environmental Protection Agency
Washington, DC 20460

ANNUAL DISPOSAL/INJECTION WELL MONITORING REPORT

Name and Address of Existing Permittee USC Saltville Brine, LLC 4800 San Felipe, Houston, TX 77056	Name and Address of Surface Owner USC Saltville Brine, LLC 4800 San Felipe, Houston, TX 77056
----------------------------------------------------------------------------------------------------------	-----------------------------------------------------------------------------------------------------

Locate Well and Outline Unit on Section Plat - 640 Acres

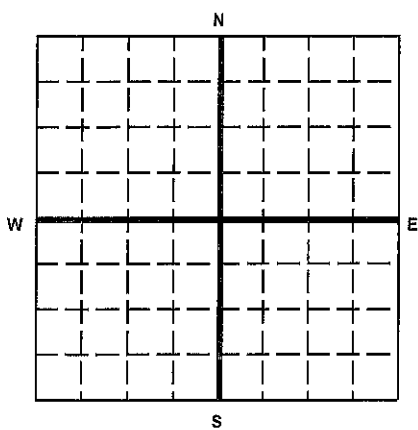

State Virginia	County Smyth/Washington	Permit Number VAS3G931BSMY
Surface Location Description 1/4 of 1/4 of 1/4 of 1/4 of Section Township Range		
Locate well in two directions from nearest lines of quarter section and drilling unit Surface Location: ft. frm (N/S) Line of quarter section and: ft. from (E/W) Line of quarter section.		
WELL ACTIVITY <input type="checkbox"/> Brine Disposal <input type="checkbox"/> Enhanced Recovery <input type="checkbox"/> Hydrocarbon Storage		TYPE OF PERMIT <input type="checkbox"/> Individual <input checked="" type="checkbox"/> Area Number of Wells 17
Lease Name: Saltville		Well Number: #131

MONTH	YEAR	INJECTION PRESSURE		TOTAL VOLUME INJECTED		TUBING -- CASING ANNULUS PRESSURE (OPTIONAL MONITORING)	
		AVERAGE PSIG	MAXIMUM PSIG	BBL	MCF	MINIMUM PSIG	MAXIMUM PSIG
January-2022		375	385	146361			
February-2022		379	413	138207			
March-2022		365	385	144610			
April-2022		350	372	134606			
May-2022		338	361	128948			
June-2022		376	382	136799			

Certification

I certify under the penalty of law that I have personally examined and am familiar with the information submitted in this document and all attachments and that, based on my inquiry of those individuals immediately responsible for obtaining the information, I believe that the information is true, accurate, and complete. I am aware that there are significant penalties for submitting false information, including the possibility of fine and imprisonment. (Ref. 40 CFR 144.32)

Name and Official Title (Please type or print) Derek Snodgrass, Brine Production Operator	Signature 	Date Signed 07/05/22
----------------------------------------------------------------------------------------------	---------------	-------------------------



United States Environmental Protection Agency
Washington, DC 20460

ANNUAL DISPOSAL/INJECTION WELL MONITORING REPORT

Name and Address of Existing Permittee
USC Saltville Brine, LLC
4800 San Felipe, Houston, TX 77056

Name and Address of Surface Owner
USC Saltville Brine, LLC
4800 San Felipe, Houston, TX 77056

Locate Well and Outline Unit on
Section Plat - 640 Acres

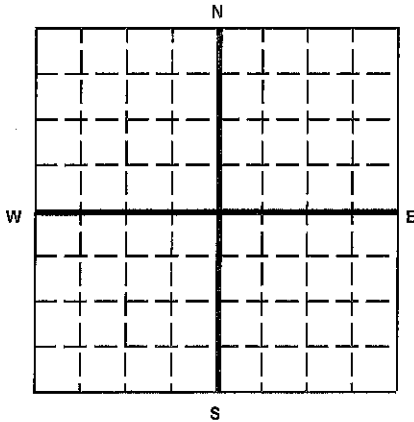

State: Virginia County: Smyth/Washington Permit Number: VAS3G931BSMY

Surface Location Description
1/4 of 1/4 of 1/4 of 1/4 of Section Township Range

Locate well in two directions from nearest lines of quarter section and drilling unit

Surface Location: ft. frm (N/S) Line of quarter section
and ft. from (E/W) Line of quarter section.

WELL ACTIVITY TYPE OF PERMIT
 Brine Disposal Individual
 Enhanced Recovery Area
 Hydrocarbon Storage Number of Wells: 17

Lease Name: Saltville Well Number: #1A

MONTH	YEAR	INJECTION PRESSURE		TOTAL VOLUME INJECTED		TUBING -- CASING ANNULUS PRESSURE (OPTIONAL MONITORING)	
		AVERAGE PSIG	MAXIMUM PSIG	BBL	MCF	MINIMUM PSIG	MAXIMUM PSIG
January-2022		51	52	0			
February-2022		52	55	0			
March-2022		51	54	0			
April-2022		50	53	0			
May-2022		48	50	0			
June-2022		49	50	0			

Certification

I certify under the penalty of law that I have personally examined and am familiar with the information submitted in this document and all attachments and that, based on my inquiry of those individuals immediately responsible for obtaining the information, I believe that the information is true, accurate, and complete. I am aware that there are significant penalties for submitting false information, including the possibility of fine and imprisonment. (Ref. 40 CFR 144.32)

Name and Official Title (Please type or print)
Derek Snodgrass, Brine Production Operator

Signature
Derek Snodgrass

Date Signed
07/05/22