

Trumbull County, Ohio - Property Record Card
 Parcel 39-005503
 Card 1

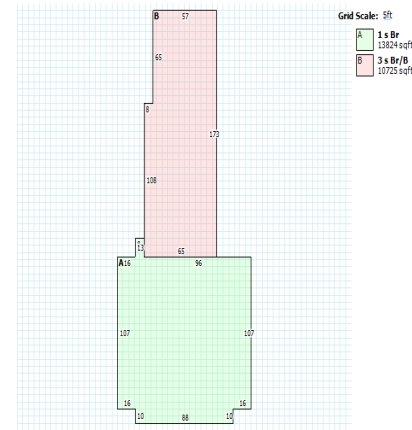

GENERAL PARCEL INFORMATION

Owner GSP ELM ROAD LLC
 Property Address 261 ELM
 Mailing Address 1650 TYSON'S BLVD
 MC LEAN VA 22102
 Land Use 499 - Other commercial structures
 Deed CURRENT DEED VOLUME/PAGE: /
 Legal Description 11&12 145.2F
 LEFFINGWELL ELM RD

VALUATION

	Appraised	Assessed
Land Value	\$49,900.00	\$17,470.00
Improvements Value	\$475,900.00	\$166,570.00
CAUV Value	\$0.00	\$0.00
Taxable Value	\$184,040.00	
Net Annual Tax		

RESIDENTIAL

LAND

Land Type	Acreage	Depth	Frontage	Depth	Value
L1 - Front Lot Entry	0.9154	275	145		49850

ADDITIONS

IMPROVEMENTS

AGRICULTURAL

SALES

Date	Buyer	Seller	Price
1/27/2022	GSP ELM ROAD LLC	GLOBAL SCHOOL	\$0.00
5/31/2017	GLOBAL SCHOOL	GLOBAL SCHOOL	\$0.00
10/8/2015	GLOBAL SCHOOL	WARREN ELM FACILITIES	\$2,000,000.
7/25/2007	WARREN ELM FACILITIES	THOMAS J TOBIN	\$300,000.00
10/7/1996	THOMAS J TOBIN	OF YOUNGSTOWN	\$0.00
10/7/1996	OF YOUNGSTOWN	BISHOP OF THE DIOCESE	\$0.00
10/7/1996	BISHOP OF THE DIOCESE	JAMES MALONE	\$0.00
1/1/1990	JAMES MALONE	Unknown	\$0.00

COMMERCIAL

Description	Classroom (Schools)
Year Built	1948
Year Remodeled	0
Unit Count	0
Section Number	1
Section Area	10802
Wall Height	18
Section Story Count	1

Grid Scale: 5ft

- A** 1 s Br
13824 sqft
- B** 3 s Br/B
10725 sqft

